



**RURAL DIRECTORS COMMITTEE
AGENDA**

Thursday, October 9, 2014

<u>PAGE NO.</u>	<u>SUPPLEMENTARY AGENDA</u>	<u>ACTION</u>
	<u>AGENDA- October 9, 2014</u>	Approve
	<u>MINUTES</u>	
3-5	Rural Directors Committee Meeting Minutes - September 4, 2014	Receive
	<u>REPORT</u>	
6-9	Cheryl Anderson, Manager of Administrative Services – Lakes District Fall Fair Association - Request for Grant in Aid – Electoral Areas “B” (Burns Lake Rural) and “E” (Francois/Ootsa Lake Rural)	Recommendation (Page 6)
10-13	Cheryl Anderson, Manager of Administrative Services – Topley Cemetery Board – Request for Grant in Aid – Electoral Areas “B” (Burns Lake Rural) and “G” (Houston Rural)	Recommendation (Page 10)
14-18	Cheryl Anderson, Manager of Administrative Services – Rip’n the North Bike Club – Request for Grant in Aid – Electoral Area “F” (Vanderhoof Rural)	Recommendation (Page 14)
19-22	Cheryl Anderson, Manager of Administrative Services – Vanderhoof Paramedics – Request for Grant in Aid – Electoral Area “F” (Vanderhoof Rural)	Recommendation (Page 19)
23-34	Deborah Jones-Middleton, Emergency Program Coordinator – Farmed Animal Mass Carcass Emergency Disposal GIS Study Results and Next Steps	Recommendation (Page 27)
35-36	Kristi Rensby, Finance/Administration Coordinator - Directors’ Allocations of Federal Gas Tax Funds - Third Quarter 2014	Receive

<u>PAGE NO.</u>	<u>DEVELOPMENT SERVICES</u> <i>(All Directors)</i>	<u>ACTION</u>
	<u>Referrals</u>	
37-44	Land Referral File No. 6408726 Burnette and McCreery Electoral Area 'A'	Recommendation (Page 37)
45-47	Land Referral File No. 7409736 K&D Logging Ltd Electoral Area 'C'	Recommendation (Page 45)
48-50	Land Referral File No. 7409737 M. Henderson and J. Hiebert Electoral Area 'C'	Recommendation (Page 48)
51-53	Land Referral File No. 7409739 Ministry of Transportation and Infrastructure Electoral Area 'D'	Recommendation (Page 51)
54-59	Land Referral File No. 284064 Warren and Kelly Labrie Electoral Area 'G'	Recommendation (Page 55)

SUPPLEMENTARY

NEW BUSINESS

ADJOURNMENT

REGIONAL DISTRICT OF BULKLEY-NECHAKO**RURAL DIRECTORS COMMITTEE MEETING****Thursday, September 4, 2014**

PRESENT: Acting Chair Bill Miller

Directors Stephen Freeman
Tom Greenaway
Rob Newell
Ralph Roy
Stoney Stoltenberg

Director Absent Jerry Petersen, Electoral Area "F" (Vanderhoof Rural)

Staff Gail Chapman, Chief Administrative Officer
Cheryl Anderson, Manager of Administrative Services
Hans Berndorff, Financial Administrator
Jason Llewellyn, Director of Planning – left at 1:14 p.m.
Wendy Wainwright, Executive Assistant

Other Taylor Bachrach, Town of Smithers

CALL TO ORDER

Acting Chair Miller called the meeting to order at 12:58 p.m.

**SUPPLEMENTARY
AGENDA, SUPPLEMENTARY
TO THE SUPPLEMENTARY
AGENDA & AGENDA**Moved by Director Roy
Seconded by Director Greenaway**RDC.2014-9-1**

"That the Supplementary Agenda and Supplementary to the Supplementary Agenda be received and dealt with at this meeting; and further, that the Agenda for September 4, 2014 be received."

(All/Directors/Majority)

CARRIED UNANIMOUSLY**MINUTES****Rural Directors Committee
Meeting Minutes
-August 14, 2014**Moved by Director Roy
Seconded by Director Stoltenberg**RDC.2014-9-2**

"That the minutes of the Rural Directors Committee meeting of August 14, 2014 be received."

(All/Directors/Majority)

CARRIED UNANIMOUSLY

REPORT

Smithers Chamber of
Commerce – Request for
Grant in Aid – Electoral Area
"A" (Smithers Rural)

Moved by Director Stoltenberg
Seconded by Director Greenaway

RDC.2014-9-3

"That the Rural Directors Committee recommend to the Regional District of Bulkley-Nechako Board of Directors that the Smithers District Chamber of Commerce be given \$157.50 grant in aid monies from Electoral Area "A" (Smithers Rural) to co-sponsor with the Town of Smithers the "Environmental Business of the Year Award" at the 2014 Community and Business Awards."

(All/Directors/Majority)

CARRIED UNANIMOUSLY

DEVELOPMENT SERVICES

REFERRALS (All Directors)

Mines File No.
1641265201401 Nils Aidan
Forsman (Dig in Contracting)
Electoral Area "C"

Moved by Director Greenaway
Seconded by Director Newell

RDC.2014-9-4

"That the comment sheet titled "Regional District of Bulkley-Nechako Comment Sheet on Mines File No. 1641265201401" be provided to the Province as the Regional District's comments on Mines File No. 1641265201401."

(All/Directors/Majority)

CARRIED UNANIMOUSLY

DISCUSSION ITEM

RDBN Chair Miller – Meeting with Northern Development Initiative Trust

Acting Chair Miller mentioned that he had met with Janine North, Chief Executive Officer, Northern Development Initiative Trust (NDIT) to discuss a funding structure for recreation sites similar to the NDIT Community Hall and Recreation Facilities Program. This funding would be project based only and the current maintenance of the recreation sites as operated by the Ministry of Forests, Lands and Natural Resources Operations would continue. Acting Chair Miller will continue to discuss the development of a funding model to address the needed repairs for recreation sites in the region with Northern Development Initiative Trust.

SUPPLEMENTARY AGENDA

DEVELOPMENT SERVICES

Land Referral File
No.7409700 CTF
Electoral Area "C"

Moved by Director Greenaway
Seconded by Director Freeman

RDC.2014-9-5

"That the comment sheet titled "Regional District of Bulkley-Nechako Comment Sheet on Crown Land Referral File 7409700 " be provided to the Province as the Regional District's comments on Crown Land Referral File 7409700."

(All/Directors/Majority)

CARRIED UNANIMOUSLY

SUPPLEMENTARY TO THE SUPPLEMENTARY AGENDA

Smithers Seniors Citizens Association – Requests for Grant in Aid– Electoral Area "A" (Smithers Rural)

Moved by Director Stoltenberg
Seconded by Director Freeman

RDC.2014-9-6

"That the Rural Directors Committee recommend to the Regional District of Bulkley-Nechako Board of Directors that the Smithers Seniors Citizens Association be given \$20,000 grant in aid monies from Electoral Area "A" (Smithers Rural) to provide flooring for a walking path at the new arena in Smithers."

(All/Directors/Majority)

CARRIED UNANIMOUSLY

ADJOURNMENT

Moved by Director Roy
Seconded by Director Freeman

RDC.2014-9-7

"That the meeting be adjourned at 1:18 p.m."

(All/Directors/Majority)

CARRIED UNANIMOUSLY

Bill Miller, Acting Chair

Wendy Wainwright, Executive Assistant

6



REGIONAL DISTRICT OF BULKLEY-NECHAKO

MEMORANDUM

TO: Chair Petersen and Rural Directors Committee

FROM: Cheryl Anderson, Manager of Administrative Services

DATE: October 1, 2014

**SUBJECT: Lakes District Fall Fair Association– Request for Grant in Aid –
Electoral Areas “B” (Burns Lake Rural) and “E”
(Francois/Ootsa Lake Rural)**

Attached is a request for Grant in Aid monies from the Lakes District Fall Fair Association.

The Association is seeking \$4,683.41 grant in aid monies from each of Electoral Areas “B” (Burns Lake Rural) and “E” (Francois/Ootsa Lake Rural) to expand and upgrade its parking area at Eagle Creek Fairgrounds.

Directors Miller and Freeman have indicated their support of this application.

RECOMMENDATION: (All/Directors/Majority)

“That the Lakes District Fall Fair Association be given \$4,683.41 grant in aid monies from each of Electoral Areas “B” (Burns Lake Rural) and “E” (Francois/Ootsa Lake Rural) to expand its parking area at Eagle Creek Fairgrounds.”

Cheryl Anderson

From: Regional District of Bulkley-Nechako <inquiries@rdbn.bc.ca>
Sent: September-01-14 3:13 PM
To: Cheryl Anderson
Subject: New submission from "Grant in Aid Application"!

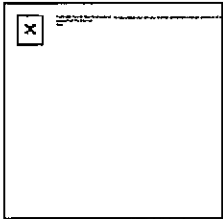

REGIONAL DISTRICT OF BULKLEY-NECHAKO
ELECTORAL AREA GRANT IN AID APPLICATION

APPLICATION SUBMITTED BY:

Lakes District Fall Fair

Mailing Address:

Box 304, Francois Lake, B.C. VOJ 1R0

Email:

jmcfee1@xplornet.ca

Contact Person:

Joan McFee (695-6381, phone and fax)

APPLICATION SUMMARY

Project or purpose for which you require assistance:

expand and upgrade our parking area up at Eagle Creek Fairgrounds

Amount Requested:

\$ 4,683.41

To the best of my knowledge, all of the information that is provided in this application is true and correct. Furthermore, I hereby certify that this application for assistance is NOT being made on behalf of an individual, industry, commercial or business undertaking.

Yes

<p>_____ (signature of authorized signatory)</p> <p>_____ (title)</p> <p>Amount Approved: _____ Date: _____</p>	<p>_____ Signature of Electoral Area Director</p>
---	---

APPLICATION PROFILE

Is your organization voluntary and non-profit?:

Yes

Please describe the services/benefits that your organization provides to the community. Are these

8

services/benefits available to the community from another organization or agency?

*We host the annual Lakes District Fall Fair.
Not available from another organization*

Describe the geographic area that receives services or benefits from your organization.

Burns Lake and the whole Lakes District

Please detail any remuneration paid, or funds otherwise made available to members, officers, etc. of your organization.:

none

Please comment on the number of members/volunteers in your organization and how long your organization has been in operation.:

We have from 150 - 200 volunteers on Fair weekend

PROJECT PROPOSAL PROFILE

RDBN Assistance Requested:

capital project and/or equipment

Other Assistance Requested:

none

Please describe the proposal for which you are requesting assistance. If you are applying for an exemption from fees and/or charges or other consideration, please provide details or your request here. Attach additional information if required:

We are in urgent need to expand and upgrade the current parking area up at the Fairgrounds

Describe how this proposal will benefit the community:

Participants and spectators will be better able to access the fairgrounds by being able to park closer to the activities and when it is wet, they should not get stuck in the ruts

FUNDING AND FINANCIAL INFORMATION

files Submitted:

Have you applied for a grant/funding from other source(s)?:

Yes

If not, please comment.:

yes

Name of Grant or Funding Agency1:
Amount Applied for 1:
Status of Grant Application1:

*FCC AgriSpirit
\$25,000.00
Pending*

Name of Grant or Funding Agency2:
Amount Applied for2:
Status of Grant Application2:

*NKDF
\$23995.00
Pending*

Name of Grant or Funding Agency3:
Amount Applied for3:
Status of Grant Application3:

*N/A
N/A*

Name of Grant or Funding Agency4:
Amount Applied for4:
Status of Grant Application4:

*N/A
N/A*

Have you received assistance before from us.

Yes

Year, Amount and Purpose for assistance

*2012, for prizes for the Loggers
Sports event at the Fair
\$1200.00*

Year, Amount and Purpose for assistance

N/A

Does your organization:

Offer direct financial assistance to individuals or families?:

Duplicate services that fall within the mandate of either:

a senior government or a local service agency?:

Provide an opportunity for individuals to make direct contributions?:

OR, is your organization: Part of a provincial or national fund raising campaign? *Yes*

**REGIONAL DISTRICT OF BULKLEY-NECHAKO****MEMORANDUM**

TO: Chair Petersen and Rural Directors Committee

FROM: Cheryl Anderson, Manager of Administrative Services

DATE: October 1, 2014

SUBJECT: Topley Cemetery Board– Request for Grant in Aid – Electoral Areas “B” (Burns Lake Rural) and “G” (Houston Rural)

Attached is a request for Grant in Aid monies from the Topley Cemetery Board.

The Board is requesting \$4,000 grant in aid monies from Electoral Area “G” (Houston Rural) for a new fence.

Directors Miller and Newell have indicated their support in each providing \$2,000 toward this application.

RECOMMENDATION: (All/Directors/Majority)

“That the Topley Cemetery Board be given \$2,000 grant in aid monies from each of Electoral Areas “B” (Burns Lake Rural) and “G” (Houston Rural) for a new fence.”

Cheryl Anderson

From: Regional District of Bulkley-Nechako <inquiries@rdbn.bc.ca>
Sent: September-03-14 9:26 AM
To: Cheryl Anderson
Subject: New submission from "Grant in Aid Application!"

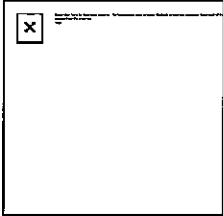

REGIONAL DISTRICT OF BULKLEY-NECHAKO
ELECTORAL AREA GRANT IN AID APPLICATION

APPLICATION SUBMITTED BY:

Topley Cemetery Board

Mailing Address:
Box 1312, Houston, BC V0J 1Z0

Email:

vsketchley@sd91.bc.ca
Marilyn Kerr 250 696 3687 or
Val Sketchley 250 696 3694

Contact Person:

APPLICATION SUMMARY

Project or purpose for which you require assistance:

Remove existing fron fence, salvaging the current gate and replacing it with a durable, quality fence.

Amount Requested:

4000.00

To the best of my knowledge, all of the information that is provided in this application is true and correct. Furthermore, I hereby certify that this application for assistance is NOT being made on behalf of an individual, industry, commercial or business undertaking.

Yes

<p>_____ (signature of authorized signatory)</p> <p>_____ (title)</p> <p>Amount Approved: _____ Date: _____</p>	<p>_____ Signature of Electoral Area Director</p>
---	---

APPLICATION PROFILE

Is your organization voluntary and non-profit?:

Yes

12

Please describe the services/benefits that your organization provides to the community. Are these services/benefits available to the community from another organization or agency?

The Topley Cemetery provides burial/cremation/memorial plots at minimal fees to residents of Topley and area. These services would be available to our residents at a much higher cost in other areas.

Describe the geographic area that receives services or benefits from your organization.

Electoral area "B" Burns Lake Rural and "G" Houston Rural. Topley and surrounding area are serviced.

Please detail any remuneration paid, or funds otherwise made available to members, officers, etc. of your organization.:

We receive an annual grant of \$1500.00 from the Regional District. The only other funds received would be from the sale of grave space for burials, cremations, or memorials.

Please comment on the number of members/volunteers in your organization and how long your organization has been in operation.:

Currently we have 5 members. I believe the cemetery was established in 1928.

PROJECT PROPOSAL PROFILE

RDBN Assistance Requested:

capital project and/or equipment

Other Assistance Requested:

Please describe the proposal for which you are requesting assistance. If you are applying for an exemption from fees and/or charges or other consideration, please provide details of your request here. Attach additional information if required:

We are requesting assistance to complete the Topley Cemetery Fence. In 2013 we hired a contractor and completed the fence on three sides of the cemetery with black chain link. The existing front fence of concrete has deteriorated and two panels have fallen out completely. We require assistance to complete the front fence with the same contractor using a commercial grade ornamental material.

Describe how this proposal will benefit the community:

Funding will complete the fence of our cemetery establishing its boundaries.

FUNDING AND FINANCIAL INFORMATION

files Submitted:

Have you applied for a grant/funding from other source(s)?: Yes

If not, please comment.:

Name of Grant or Funding Agency1: Bulkley Valley Credit Union
Amount Applied for 1: 1550.00
Status of Grant Application1: Pending

Name of Grant or Funding Agency2: Dungate Community Forest
Amount Applied for2: 1550.00
Status of Grant Application2: Pending

Name of Grant or Funding Agency3:
Amount Applied for3:
Status of Grant Application3:

Name of Grant or Funding Agency4:
Amount Applied for4:
Status of Grant Application4:

Have you received assistance before from us. No

Year, Amount and Purpose for assistance
Year, Amount and Purpose for assistance

Does your organization:
Offer direct financial assistance to individuals or families?:
Duplicate services that fall within the mandate of either:
a senior government or a local service agency?:
Provide an opportunity for individuals to make direct contributions?:
OR, is your organization: Part of a provincial or national fund raising
campaign?:

**REGIONAL DISTRICT OF BULKLEY-NECHAKO****MEMORANDUM**

TO: Chair Petersen and Rural Directors Committee

FROM: Cheryl Anderson
Manager of Administrative Services

DATE: October 1, 2014

SUBJECT: Rip'n the North Bike Club– Request for Grant in Aid – Electoral Area “F” (Vanderhoof Rural)

Attached is a request for Grant in Aid monies from Rip'n the North Bike Club.

The Club is seeking \$1,500 from Electoral Area “F” (Vanderhoof Rural) grant in aid monies for the purchase of a trail cam.

Director Petersen has indicated that he is supportive of this application.

RECOMMENDATION: (All/Directors/Majority)

“That the Rural Directors Committee recommend to the Regional District of Bulkley-Nechako Board of Directors that Rip'n the North Bike Club be given \$1,500 grant in aid monies from Electoral Area “F” (Vanderhoof Rural) for the purchase of a trail cam.”

Cheryl Anderson

From: Regional District of Bulkley-Nechako <inquiries@rdbn.bc.ca>
Sent: September-15-14 1:13 PM
To: Cheryl Anderson
Subject: New submission from "Grant in Aid Application"
Attachments: 54174847cf335-Trail Cam quote.pdf

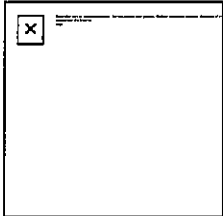

REGIONAL DISTRICT OF BULKLEY-NECHAKO
ELECTORAL AREA GRANT IN AID APPLICATION

APPLICATION SUBMITTED BY:

Rip'n the North Bike Club

Mailing Address:
Box 1629 Vanderhoof, BC V0j 3A0

Email:
Contact Person:

wfitzpatrick@sd91.bc.ca
Wade Fitzpatrick, 250-567-4372

APPLICATION SUMMARY

Project or purpose for which you require assistance:

Rip'n the North Bike Club has three main priorities: Safety, Maintenance, and Development. The bike club is asking for \$ 1500 in order to assist with the safety and future development of its community bike park and trails. The issue the bike club is currently dealing with is this. Over the past two years our main gate has been vandalized by vehicles driving into it repeatedly. Our gate has been replaced at a cost of \$ 1700 to the club. This money should of been used for maintenence and development of our community bike park and trails. In order to be as proactive as possible we would like to purchses a trail cam along with a 'dummy' cam in order to provide some security for our park. We feel that this purchase will detter the vandalism to our gate and allow all our funds to be devoted to our maintenance and development plans. The second benefit to installing a trail cam at the community bike park is that it will allow Rip'n the North Bike Club to monitor the a mount of users at out park. By having some solid data, the bike club will pursue other grants to assist with our maintenance and development plans.

Amount Requested:

\$1500

To the best of my knowledge, all of the information that is provided in this application is true and correct. Furthermore, I hereby certify that this application for assistance is NOT being made on behalf of an individual,

Yes

industry, commercial or business undertaking.

_____	_____	_____
(signature of authorized signatory)	(title)	Signature of Electoral Area Director
Amount Approved: _____		
Date: _____		

APPLICATION PROFILE

Is your organization voluntary and non-profit?: Yes

Please describe the services/benefits that your organization provides to the community. Are these services/benefits available to the community from another organization or agency?

The Vanderhoof Bike Park is accessed by all ages of our local community. It is a place where riders can safely develop their skills on the bike by building their confidence slowly with our progressive stunts and terrain. We are the only bike park in our community. As a result, Rip'n the North Bike Park is the foundation for biking in the Vanderhoof area. of the biking

Describe the geographic area that receives services or benefits from your organization.

The community of Vanderhoof and surrounding area benefit from our bike park. Without this park and trails, local people would need to drive to Burns Lake, Fort Saint James or Prince George to enjoy the same type of riding that our bike park offers in its jumps, drops, wall ride and various trails.

Please detail any remuneration paid, or funds otherwise made available to members, officers, etc. of your organization.:

We are a voluntary club. All grants and money received is used for safety, maintenance and development of mountain biking in the community of Vanderhoof.

Please comment on the number of members/volunteers in your organization and how long your organization has been in operation.:

Rip'n the North Bike Club was founded in 2007 and has been maintaining our bike park in safe manner since then. In 2014 we have three main directors who have created a plan a plan of safety, maintenance, and development. For development, we want to have the highest quality trails and jumps in our region. At the same time we also want to develop and grow the membership of our club in order that the bike park and trails remain a part of our community in the future.

PROJECT PROPOSAL PROFILE

RDBN Assistance Requested: *capital project and/or equipment*

Other Assistance Requested:

Please describe the proposal for which you are requesting assistance. If you are applying for an exemption from fees and/or charges or other consideration, please provide details of your request here. Attach additional information if required:

Rip'n the North Bike Club has three main priorities: Safety, Maintenance, and Development. The bike club is asking for \$ 1500 in order to assist with the safety and future development of its community bike park and trails. The issue the bike club is currently dealing with is this. Over the past two years our main gate has been vandalized by vehicles driving into it repeatedly. Our gate has been replaced at a cost of \$ 1700 to the club. This money should of been used for maintenence and development of our community bike park and trails. In order to be as proactive as possible we would like to purchses a trail cam along with a 'dummy' cam in order to provide some security for our park. We feel that this purchase will detter the vandalism to our gate and allow all our funds to be devoted to our maintenance and development plans. The second benefit to installing a trail cam at the community bike park is that it will allow Rip'n the North Bike Club to monitor the a mount of users at out park. By having some solid data, the bike club will pursue other grants to assist with our maintenance and development plans.

Describe how this proposal will benefit the community:

This proposal will benefit the community of Vanderhood in several areas:

- 1) Appearance - Having an entrance to our park that is maintained provokes interest and a sense of pride in our park. The community can instantly notice that the park is being monitored and cared for.*
- 2) Use future grant money to pursue development and maintenance of our trails and bike park instead of dealing with the costs of vandalism.*
- 3) Ability to monitor amount of users riding at our park. This will allow the bike club to access future grants to maintain and develop mountain biking in Vanderhoof.*

FUNDING AND FINANCIAL INFORMATION

files Submitted:

*54174847cf335-Trail Cam
quote.pdf*

Have you applied for a grant/funding from other source(s)?:

Yes

If not, please comment.:

Name of Grant or Funding Agency1:

Integris Community Foundation

Amount Applied for 1:

\$5000

Status of Grant Application1:

Pending

Name of Grant or Funding Agency2:
Amount Applied for2:
Status of Grant Application2:

Name of Grant or Funding Agency3:
Amount Applied for3:
Status of Grant Application3:

Name of Grant or Funding Agency4:
Amount Applied for4:
Status of Grant Application4:

Have you received assistance before from us.

Yes

Year, Amount and Purpose for assistance

2009, \$2500, To bring Ride guide film crew to Vanderhoof and film a segment

Year, Amount and Purpose for assistance

Does your organization:

Offer direct financial assistance to individuals or families?:

Duplicate services that fall within the mandate of either:
a senior government or a local service agency?:

Provide an opportunity for individuals to make direct
contributions?:

OR, is your organization: Part of a provincial or national fund
raising campaign?:

**REGIONAL DISTRICT OF BULKLEY-NECHAKO****MEMORANDUM**

TO: Chair Petersen and Rural Directors Committee

FROM: Cheryl Anderson
Manager of Administrative Services

DATE: October 1, 2014

SUBJECT: Vanderhoof Paramedics – Request for Grant in Aid – Electoral Area “F” (Vanderhoof Rural)

Attached is a request for Grant in Aid monies from the Vanderhoof Paramedics.

The Club is seeking \$1,374.67 from Electoral Area “F” (Vanderhoof Rural) grant in aid monies for the purchase of medical equipment for patient care.

Director Petersen has indicated that he is supportive of this application.

RECOMMENDATION: (All/Directors/Majority)

“That the Rural Directors Committee recommend to the Regional District of Bulkley-Nechako Board of Directors that the Vanderhoof Paramedics be given \$1,374.67 grant in aid monies from Electoral Area “F” (Vanderhoof Rural) for the purchase of medical equipment for patient care.”

Cheryl Anderson

From: Regional District of Bulkley-Nechako <inquiries@rdbn.bc.ca>
Sent: September-09-14 7:38 PM
To: Cheryl Anderson
Subject: New submission from "Grant in Aid Application!"
Attachments: 540fb98a35f65-letter for RDBN.docx

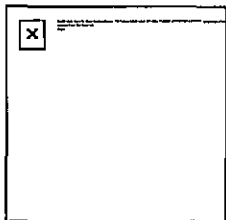

REGIONAL DISTRICT OF BULKLEY-NECHAKO
ELECTORAL AREA GRANT IN AID APPLICATION

APPLICATION SUBMITTED BY:

Vanderhoof Paramedics

Mailing Address:

PO Box 1247 Vanderhoof BC V0J3A0

Email:

karen.wiebe@ehsbc.ca

Contact Person:

Karen Wiebe 250-567-7924

Fax 250-567-9616

APPLICATION SUMMARY

Project or purpose for which you require assistance:

Equipment

Amount Requested:

1374.67

To the best of my knowledge, all of the information that is provided in this application is true and correct. Furthermore, I hereby certify that this application for assistance is NOT being made on behalf of an individual, industry, commercial or business undertaking.

Yes

<p>_____ (signature of authorized signatory)</p> <p>_____ (title)</p> <p>Amount Approved: _____ Date: _____</p>	<p>_____ Signature of Electoral Area Director</p>
---	---

APPLICATION PROFILE

Is your organization voluntary and non-profit?:

No

Please describe the services/benefits that your organization provides to the community. Are these services/benefits available to the community from another organization or agency?

Emergency Medical Assistance and medical transfers to higher levels of care. There is no other agency that does this

Describe the geographic area that receives services or benefits from your organization.

Vanderhoof, Fort Fraser, Fraser Lake, Fort St James and Burns Lake

Please detail any remuneration paid, or funds otherwise made available to members, officers, etc. of your organization.:

None

Please comment on the number of members/volunteers in your organization and how long your organization has been in operation.:

There are 15 Paramedics in Vanderhoof. The Vanderhoof Station has been in operation under the same platoon model since 1984.

PROJECT PROPOSAL PROFILE

RDBN Assistance Requested:

capital project and/or equipment

Other Assistance Requested:

Please describe the proposal for which you are requesting assistance. If you are applying for an exemption from fees and/or charges or other consideration, please provide details or your request here. Attach additional information if required:

We are asking for funds to purchase medical equipment for patient care.

Describe how this proposal will benefit the community:

Please see attached letter

FUNDING AND FINANCIAL INFORMATION

files Submitted:

540fb98a35f65-letter for RDBN.docx

Have you applied for a grant/funding from other source(s)?:

No

If not, please comment.:

Name of Grant or Funding Agency1:

Amount Applied for 1:

Status of Grant Application1:

Name of Grant or Funding Agency2:

Amount Applied for2:

Status of Grant Application2:

Name of Grant or Funding Agency3:

Amount Applied for3:

Status of Grant Application3:

Name of Grant or Funding Agency4:

Amount Applied for4:

Status of Grant Application4:

Have you received assistance before from us.

No

Year, Amount and Purpose for assistance

Year, Amount and Purpose for assistance

Does your organization:

Offer direct financial assistance to individuals or families?:

Duplicate services that fall within the mandate of either:

a senior government or a local service agency?:

Provide an opportunity for individuals to make direct contributions?:

OR, is your organization: Part of a provincial or national fund raising **Yes** campaign?:



Regional District of Bulkley-Nechako Memo OCTOBER 9, 2014

To: Chair Petersen and the Rural Directors Committee
From: Deborah Jones-Middleton (Emergency Program Coordinator)
Date: September 30, 2014
Regarding: Farmed Animal Mass Carcass Emergency Disposal GIS Study
Results and Next Steps

On June 24, 2014 the Regional District of Bulkley-Nechako received the completed 'GIS Study to Identify Potential Burial Sites' that are expected to meet the Ministry of Agriculture Protocol #1, a diagram of which is attached for your reference. Below is a summary of the results of the study.

Results

The individual soil associations for the Soils of BC coverage were classed into the three suitability ratings. Ten were found to be most likely suitable, and fourteen were found to be possibly suitable. These are listed in Table 5.

The results of the classification (including both the Soils of BC and Surficial Geology layers) are given in Table 6. An overview map of the results of the study is attached. The most suitable areas were found to be glaciolacustrine deposits, and morainal material with a high proportion of fines; these are generally found on valley bottoms and mid-slope positions. Higher elevation sites were generally found to have much coarser and more rapidly-draining surficial materials.

Table 5: Suitability Classification of Soil Associations

High	Moderate	
BARRETT (BA)	KNEWSTUB (KB)	CRONIN (CN)
DESERTERS (D)	PURDEN (PR)	CRYSTAL (CR)
FT. ST. JAMES (FJ)	BEDNESTI (B)	DRIFTWOOD (DD)
PINEVIEW (P)	BABINE (BE)	KWUN (KN)
VANDERHOOF (V)	BERMAN (BN)	SKEENA (SN)
BARRETT (BA)	CAUSQUA (CA)	TATIN (TT)
DESERTERS (D)	COBB (CB)	TWAN (TW)
FT. ST. JAMES (FJ)		
PINEVIEW (P)		
VANDERHOOF (V)		

Table 6: Results of Soil Unit Polygon Selection (See attached map)

Suitability	Number of Polygons	Area of Polygons (km ²)	Percentage of Covered Area
Most Likely Suitable Soils (high)	7873	31300	45%
Possibly Suitable Soils (moderate)	5609	16454	23%
Unsuitable Soils (low) or unknown	10834	22333	32%

NEXT STEPS

The RDBN has now completed the first three phases, Preparing a Plan, Exercising the Plan, and a 'GIS Study to Identify Potential Burial Sites', of a potential six phases of the Farmed Animal Mass Carcass Emergency Disposal Planning Process.

During the RDBN FAMCDEP Exercise Recommendations 3 and 4 were identified due to concerns with disposal in the event of a mass carcass event where the animals are unable to be buried or composted on the Farm of Origin. This may occur in many circumstances including but not limited to the following:

- wildfire event where livestock on range expire;
- cattle liner accident;
- flooding event where livestock have been pulled downstream and washed up off the farm of origin;
- the farm of origin does not meet the following criteria for burial or composting purposes:

Burial	Composting
Sites should be at least 10m above the high water table and 300m away from wells or watercourses used for domestic purposes. Locations above an existing aquifer are excluded due to the potential for contamination.	Sites should be at least 1 m above the high water table and 30 m away from wells or watercourses used for domestic purposes. Flood prone areas, steep slopes and bedrock will not be considered.
Flood prone areas, steep slopes and bedrock are not acceptable and will not be considered.	Sites should be on high ground with good drainage where pooling of water does not occur.
Sites should be at least 400m from provincial highways, 100m from provincial roads or railroads and 300m from private residences.	The preferred base is a concrete pad, asphalt or packed gravel, however a field with vegetative cover can be used if it will support equipment and leachate can be effectively contained.
Access to the site must be suitable for heavy equipment and the delivery of livestock carcasses in transporter trucks.	Access to the site must be suitable for the delivery of livestock carcasses in transporter trucks.
Sites must have soils with good stability capable of withstanding the weight of equipment used to construct and fill the pits.	The site should be shielded from public view and secure from animal predators.

The current RDBN FAMCDEP identifies the Regional District of Bulkley-Nechako Knockout and Clearview landfills as designated to receive SRM waste; however the disposal of more than one or two large carcasses could cause significant sloping issues.

To address these potential issues Investment Agriculture Foundation of BC (IAFBC) is prepared to fund the Regional District of Bulkley-Nechako for the cash costs of hiring consultants and/or contractors to carry out the action items for the following phase:

Phase 4: Short List Suitable Sites for Further Investigation

Objective:

To develop a short list of suitable sites for drilling investigation for each of the subareas of the study, that could serve each of the areas as follows:

- Electoral Area 'E', François/Ootsa Lake Rural on the south side of François Lake;
- Electoral Area 'B', Burns Lake Rural, Electoral Area 'D', Fraser Lake Rural to the west, and Electoral Area 'E', François/Ootsa Lake Rural on the north side of François Lake;
- Electoral Area 'A', Smithers Rural and Electoral Area 'G', Houston Rural; and
- Electoral Area 'C', Fort St. James Rural, Electoral Area 'D', Fraser Lake Rural to the east, Electoral Area 'F', Vanderhoof Rural.

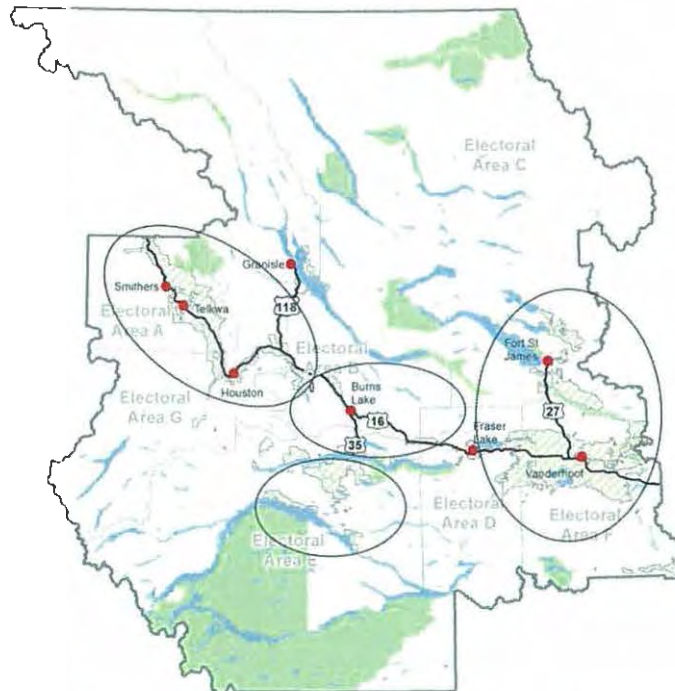

Actions:

- Inspect possible sites and prioritize the suitable ones.
- Meet with interested stake holders and obtain buy in on best sites in each subarea.

Time Frame:

The project has field work that cannot be started until next spring or summer and is estimated to be completed by September 2015.

Cost Estimate:

IAFBC: 100% of the cost of Project Coordinator including travel and reporting.

RDBN: Approximately 40 hours of GIS staff time to work with consultants on mapping needs, and one day of Protective Services staff time to coordinate activities and organize meetings.

After Phase 4: Short List Suitable Sites for Further Investigation is completed the last two phases could be considered. A brief description of Phase 5: Proof of Site Suitability and Phase 6: Permitting are described below.

Phase 5: Proof of Site Suitability

Objective:

To verify soil and groundwater meet requirements at selected sites.

Actions:

- Conduct electro-magnetic survey of each site to determine soil variability.
- Select a minimum of three locations to drill at each site.
- Drill down 10 to 12 meters, characterize and classify the subsurface soils, collecting soil samples for hydraulic conductivity testing, and install piping to allow groundwater monitoring.
- Monitor ground water levels during this phase.
- Determine soil hydraulic conductivity at each drill hole.

Time Frame:

The project will begin after the Short List Suitable Sites for Further Investigation is completed and could take up to one and half years as permits will need to be acquired on crown land.

Cost Estimate:

IAFBC: 100% of the cost for two consultants including travel, applications and reporting.

RDBN: One day of staff time to organize and attend meetings. If the Regional District of Bulkley-Nechako decides to proceed with this stage the Ministry of Agriculture has agreed to take the lead on this phase.

Phase 6: Permitting

Objective:

To obtain provincial and federal permits required to use the chosen site(s) in an emergency.

Actions:

- Apply for the permits – Ministry of Forest, Land and Natural Resource Operations application to amend Regional District of Bulkley-Nechako Solid Waste Management Plan and/or application for Crown Land Lease, and Canadian Food Inspection Agency permit.
- Conduct public consultation where required.
- Develop mitigation actions if required.
- Monitor ground water levels during this phase.
- Meet with interested stake holders and explain the results of the project.

Time Frame:

The project will begin after the Proof of Site Suitability is completed and may take between twelve and eighteen months to complete (depends on what issues are raised during the consultation process).

Cost Estimate:

IAFBC: 100% of the cost for consultant including travel, applications, consultation, and reporting.

RDBN: One day of staff time to organize and attend meetings. If the Regional District of Bulkley-Nechako decides to proceed with this stage the Ministry of Agriculture has agreed to take the lead on this phase.

Recommendation

AII /DIRECTORS/MAJORITY

1. The Rural Directors Committee receives the memo entitled “Farmed Animal Mass Carcass Emergency Disposal GIS Study Results and Next Steps” from Deborah Jones-Middleton, Protective Services Manager.
 2. The Rural Directors Committee recommend the Regional District of Bulkley-Nechako Board receive the “Farmed Animal Mass Carcass Emergency Disposal GIS Study Results and Next Steps”.
 3. The Rural Directors Committee recommend the Regional District of Bulkley-Nechako Board approve staff to apply for funding from Investment Agriculture Foundation of British Columbia for Phase Four of the project.
-

BC Ministry of Agriculture and Lands

Protocol #1

Protocol for On-Farm and Centralized Burial of Infected and Non-Infected Poultry and Livestock

Final

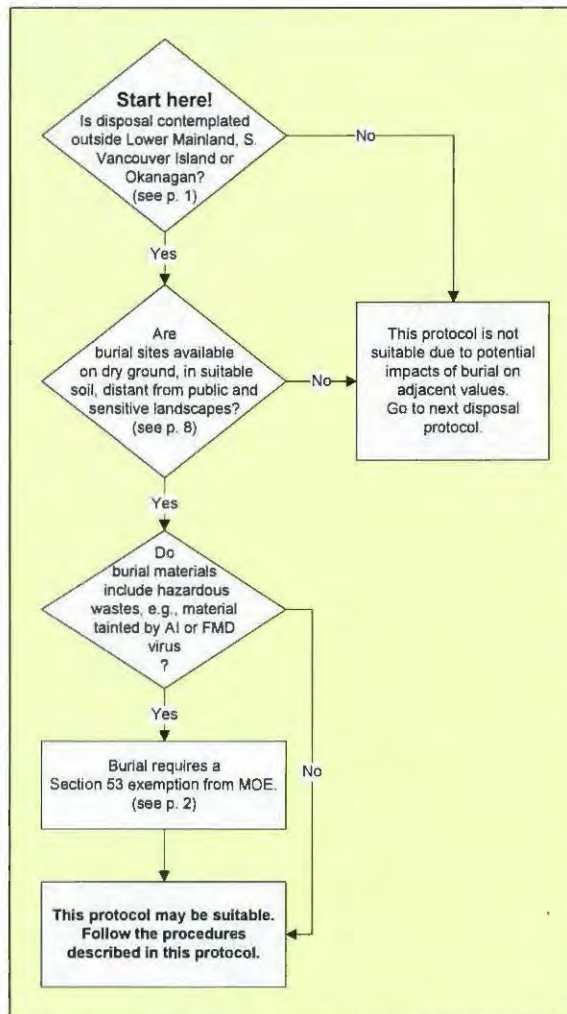

Use this decision flow-chart to determine if this protocol applies to the situation at hand.

August 20, 2010

29
Emergency Carcass Burial Project
Regional District of Bulkley-Nechako

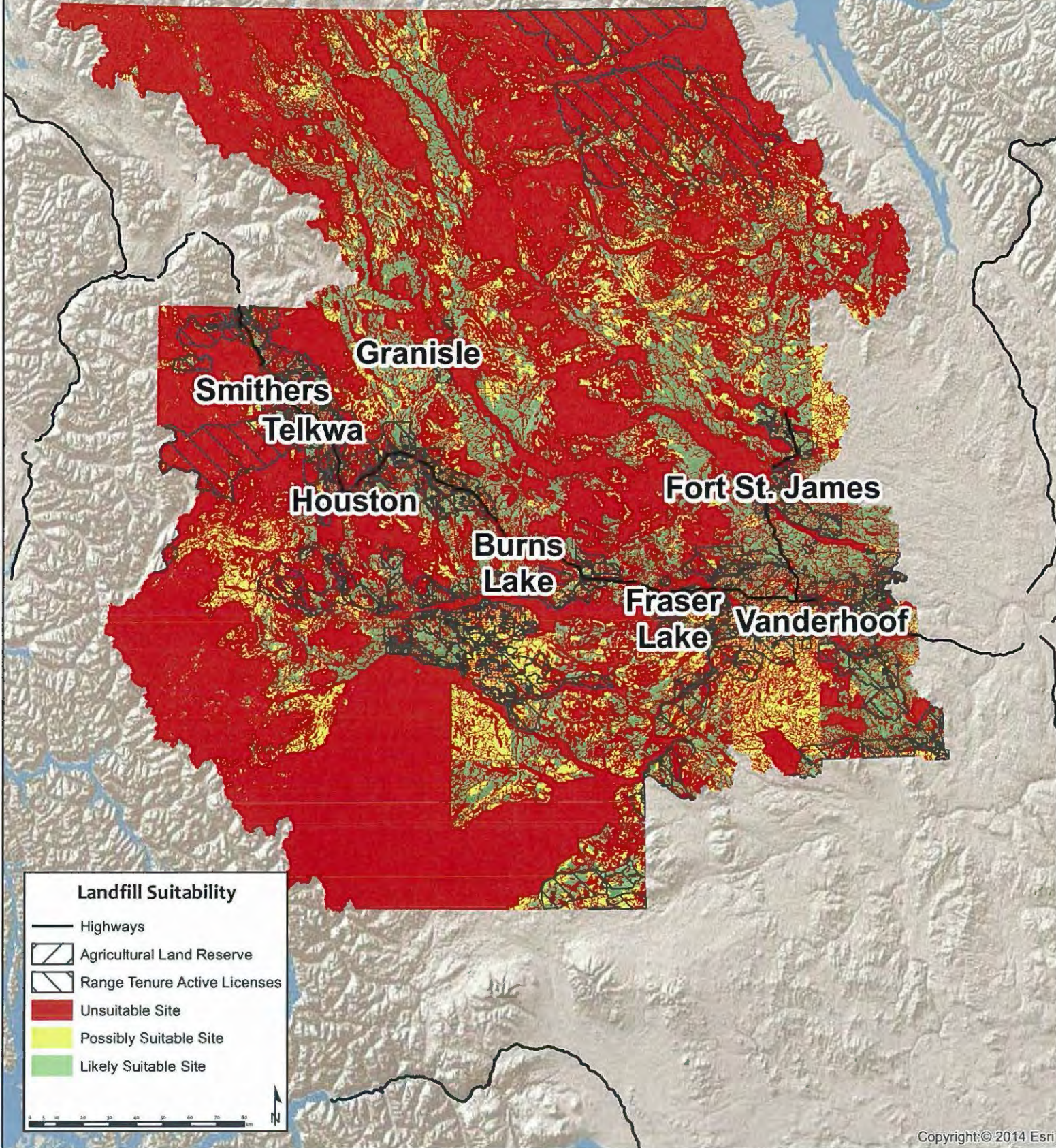

Tuesday, September 2, 2014

BC Emergency Animal Carcass Burial Site Identification Project
Proposal for Preparation of Short List of Potential Sites for Drilling Investigation

This proposal is presented by Victor R Klassen, P.Eng. of VRK Consulting Inc., in cooperation with John C Oosterveen, P.Eng. of ProFessional Resource Assessment Ltd (PFRA) to prepare a ranked short list of potential sites in each targeted sub-area of each Regional District (RD) in BC wanting to have a short list of potential sites for emergency carcass burial as described in BC Ministry of Agriculture and Lands (MAL) Protocol #1. This list could be used to select the top ranked potential sites for drilling investigations which, if confirmed to be suitable based on the investigations, could be certified for emergency carcass burial and thus be available in perpetuity for the intended purpose.

Victor R Klassen, P.Eng. has worked extensively finding emergency carcass burial sites in the 4 western provinces while employed with Agriculture and Agri-Food Canada (AAFC) as a geotechnical engineer including the pilot project for BC in Peace River conducting geotechnical investigations. He was subsequently contracted as a consultant to coordinate the Geographical Information System (GIS) studies conducted in BC for emergency carcass burial site identification. Victor currently resides in Qualicum Beach and is a registered professional engineer in BC.

John C Oosterveen has worked extensively in the 4 western provinces as an engineering geologist while working for AAFC including developing extensive expertise in conducting and interpreting Electro-Magnetic (EM)31 non-intrusive geophysical surveys. John also worked on the pilot project in Peace River conducting EM31 surveys and geological assessments. John now operates as a consultant and currently resides in Winnipeg. John is eligible for registration as a professional engineer in BC.

Cost estimates are being prepared including potential work by third parties for submission if the proposed process is approved.

Background processes:

- VRK to consult with RD representatives to review the planning maps prepared during the GIS study and confirm the locations and number of sub-areas in the regional district where emergency carcass burial sites are required as discussed at the presentation of results of the GIS study.
- Establish communication with RD GIS specialist and review process for identifying potential sites for detailed review based on the GIS mapping resultant polygon layer of



green (likely suitable) and yellow (possibly suitable) sites in each of the targeted sub-areas.

- It is expected that VRK will work closely with the RD GIS specialist during the preparation of the short list to ensure that the needs and wishes of the RD are addressed. This may require approximately 40 hours of time for the RD GIS specialist. Where possible, McElhanney Consulting (who conducted the initial GIS mapping) will be utilized to provide GIS mapping services to minimize the work required of the RD GIS specialist. It is proposed that VRK Consulting will contract McElhanney directly with no handling charges so that McElhanney will report directly to VRK Consulting. Other third party service providers will be handled in a similar manner. It is envisioned that the work will be carried out in 8 stages as follows:

Stage 1) Assessment of possibly suitable moraine sites (yellow) – McElhanney Consulting

McElhanney to provide a GIS map layer of morainal sites in yellow and green categories. McElhanney to indicate how many types of moraine are present in each category and provide details of each type. Include a table same as the table in the initial GIS study report for yellow and green moraine so that we can subtract the results of the proposed study from initial GIS study to see the difference in number of sites potentially made available if we were to investigate yellow morainal sites in more detail. Including the green morainal sites will give us an idea of the benefit of further investigation of yellow moraine sites if there are green moraine sites in the vicinity.

Note that revising the suitability criteria will not only benefit the selection of regional burial sites but will also enhance the possibility that on-farm burial will be suitable to minimize the use of landfills or regional burial sites.

Stage 2) Initial screening of sites defined in resultant polygon layer of green sites. Ensure that all landfill and waste transfer sites are included – McElhanney Consulting

McElhanney to update GIS mapping as per the following:

- Remove from the list all private deeded land and First Nations land.
- Compare list of compatible and non-compatible tenures to tenures identified in the initial GIS study mapping. (Checking with McElhanney to confirm that tenure types were included in their mapping). Remove from the list all sites with non-compatible tenures. Examples of non-compatible tenures are community recreation areas such as ballparks and campgrounds.

- Remove from the list all polygons or portions of polygons where torrent flows are identified as obtained from the MoE website.
- Update mapping of access roads to include all public and private roads such as logging and mining roads as available from the MoE website and mark as private or public. Remove from the list all sites where access is greater than 1 km from the site.
- Show water well locations on map including 300m buffer and also watercourses including 100m buffer.
- Produce revised resultant polygon layer map with remaining sites shown with a green boundary around perimeter of site showing orthophoto within the green site boundary.

Stage 3) Evaluate initial screening of mapping results with preliminary table of rating and ranking. Rating criteria out of maximum 3 are proposed – Vic Klassen

- Access adjacent to public road (3) access adjacent to private road (2) access up to 1 km away (1)
- Orthophoto review – unobstructed and suitable landuse (3) slightly difficult to survey or drill, or marginally unsuitable landuse (2) difficult to survey or drill, or possibly unsuitable landuse (1)
- GW well data (review prelim from MoE website) no wells in vicinity or deep (3) wells adjacent but deep (2) wells adjacent shallow but likely acceptable
- Proximity to watercourse - far away (3), somewhat far away (2) close proximity but likely acceptable (1)
- Rank sites based on the above. Conference call review of results with RD staff, Rick, MAL and VRK to assess if sufficient sites to proceed to Stage 4. If not, assess whether an investigative assessment of moraine might provide additional green sites in which case a funding amendment would be required plus additional time or repeat Stages 2 and 3 with yellow possibly suitable sites.
- Identify which sites to go Stage 4

Stage 4) Geological information on list of sites from Stage 3 – John Oosterveen

- Surficial geology is available from initial GIS mapping either referencing embedded mapping information details as provided by Westrek Geotechnical. Obtainable from McElhanney if not directly from GIS mapping

- John Oosterveen to prepare geological assessment of potential sites to assess suitability of each site based on Protocol #1 criteria
 - Obtain surficial geology as per previous bullet
 - Obtain sub-surface geological information from MoE website
 - Obtain water well data from MoE website
- Rate Initial ranking of sites to pick best 10 in each sub-area.
- If existing waste transfer or abandoned landfill sites are still on list, check RD for existing subsurface information such as testhole logs or groundwater levels.
- If insufficient number of sites, could go back to McElhanney and regenerate mapping using 10% slope instead of 5% as speculative approach (optional).
- Rate and rank sites picking best 10 (max) in each sub-area for site inspection.

Stage 5) Inspection – Vic Klassen and John Oosterveen

- PFRA to mobilize by vehicle from Winnipeg with EM31 and related GPS equipment to pick up Victor at regional airport and together inspect best 10 (max) sites in each sub-area checking out road cuts, Dutch auger holes, site difficulties, public separation to avoid direct viewing of potential burials, etc.
- Rate and rank sites to pick best 6 (max) in each sub-area for EM31 surveys by John Oosterveen assisted by Vic Klassen. The EM surveys/site inspections are best conducted together (VRK and PFRA) for safety and efficiency.

Stage 6) EM survey – John Oosterveen and Vic Klassen

- Conduct EM31 surveys on best 6 (max) sites in each sub-area plus any sites where moraine investigations were conducted for reference.
- Compile EM surveys and interpret, update geological assessments, and re-rank.

Stage 7) Presentation to stakeholders – Vic Klassen

- Presentation to stakeholders including RD board and staff, Cattlemen's Associations and/or First Nations for feedback.
- Re-rank based on feedback from stakeholders.

Stage 8) Reporting of results

- VRK to report to RD and MAL with all information obtained during the proposed study including the following:
 - Summary of initial GIS mapping results including the rationale for selection of the sub-areas chosen for the study, locations and numbers of sub-areas in the regional district where emergency carcass burial sites are required (background processes), and the ranking and re-ranking of sites in stage 7 to have a record of stakeholder feedback
 - Description of all stages of the proposed study and decisions made during the process
 - a ranked table of the sites referencing all related information including EM surveys
 - GIS mapping results

Respectfully submitted

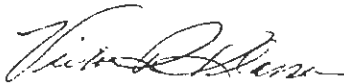

Victor R Klassen, P.Eng
VRK Consulting Inc.



**Regional District of Bulkley-Nechako
Rural Directors Committee Memorandum
October 9, 2014**

To: Chair Petersen and Rural Directors
From: Kristi Rensby, Finance/Administration Coordinator
Date: September 29, 2014
Regarding: Directors' Allocations of Federal Gas Tax Funds – Third Quarter 2014

The Directors' Allocations of the Federal Gas Tax Funds have been updated for the third quarter of 2014 as per the enclosed spreadsheet.

If you have any questions, I would be pleased to discuss them further with you.

RECOMMENDATION:	(All/Directors/Majority)
That the Rural Directors Committee receive the Finance/Administration Coordinator's September 29 th memorandum titled "Directors' Allocations of Federal Gas Tax Funds – Third Quarter 2014".	

Updated as of September 30, 2014

Federal Gas Tax Community Works Fund

Year: 2014

Electoral Area	Population	Opening Balance 2014	Interest Earnings	Funds Spent	Funds Committed	Funding Received	YTD Funds Available
A	5,391	1,340,477.42	9,486.93	147,583.40	190,081.56	136,404.73	1,148,704.12
B	2,102	276,276.21	1,975.19	53,150.00	-	53,185.45	278,286.85
C	1,429	316,175.58	2,240.82	8,704.00	-	36,157.00	345,869.40
D	1,734	451,948.14	3,196.88	-	250,000.00	43,874.20	249,019.22
E	1,507	194,010.31	1,387.66	32,964.25	75,300.00	38,130.58	125,264.30
F	3,702	770,169.71	5,462.85	98,562.24	115,693.17	93,669.14	655,046.29
G	975	39,306.21	294.59	-	-	24,669.75	64,270.55
	16,840	3,388,363.58	24,044.93	340,963.89	631,074.73	426,090.84	2,866,460.73

26



MEMORANDUM

To: Rural Directors
 From: Maria Sandberg, Planner
 Date: September 18, 2014
 Re: Land Referral File No. 6408726

This application is regarding the direct sale of Crown Land for extensive agricultural purposes. The application area is located approximately 12 kilometres east of the Village of Telkwa, and is ± 64.7 ha in size. The applicants own land adjacent to the application area.

Location Map

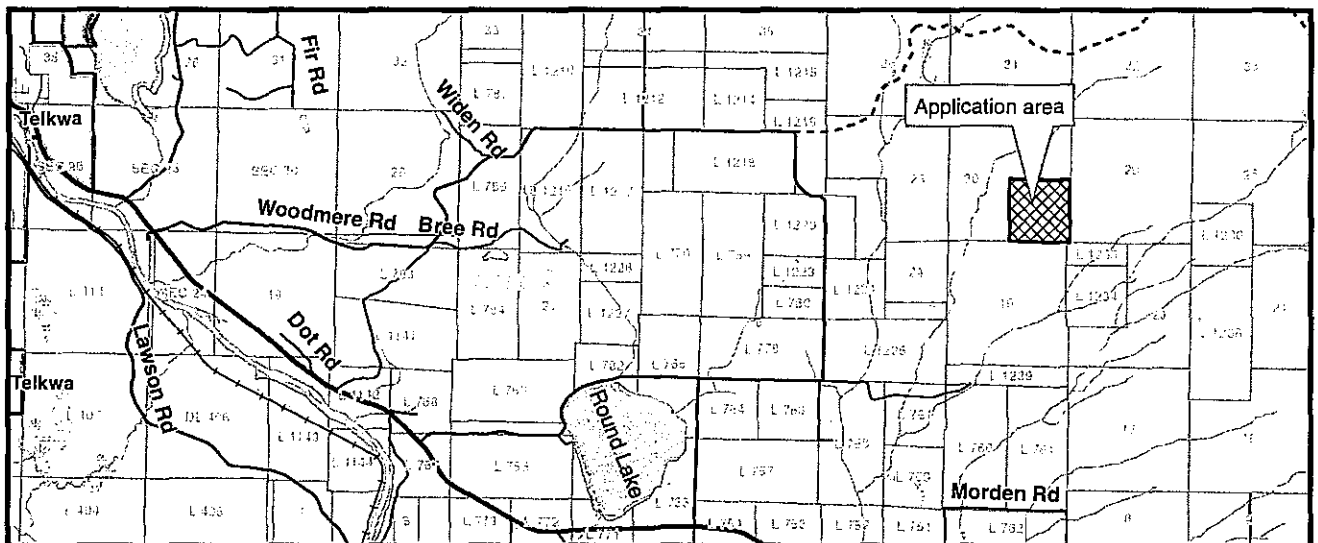

The application area is within the Agricultural Land Reserve (ALR), and is zoned Agricultural (Ag1). Agriculture is a permitted use in this zone and the proposed agricultural use of the application area complies with Regional District Zoning Bylaw No. 700, 1993.

Recommendation

That the attached comment sheet be provided to the Province as the Regional District's comments on Crown land application 6408726.

Rural Directors – All/Directors/Majority

Reviewed by:

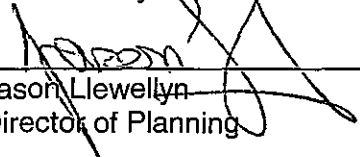
 Jason Llewellyn
 Director of Planning

Written by:

 Maria Sandberg
 Planner



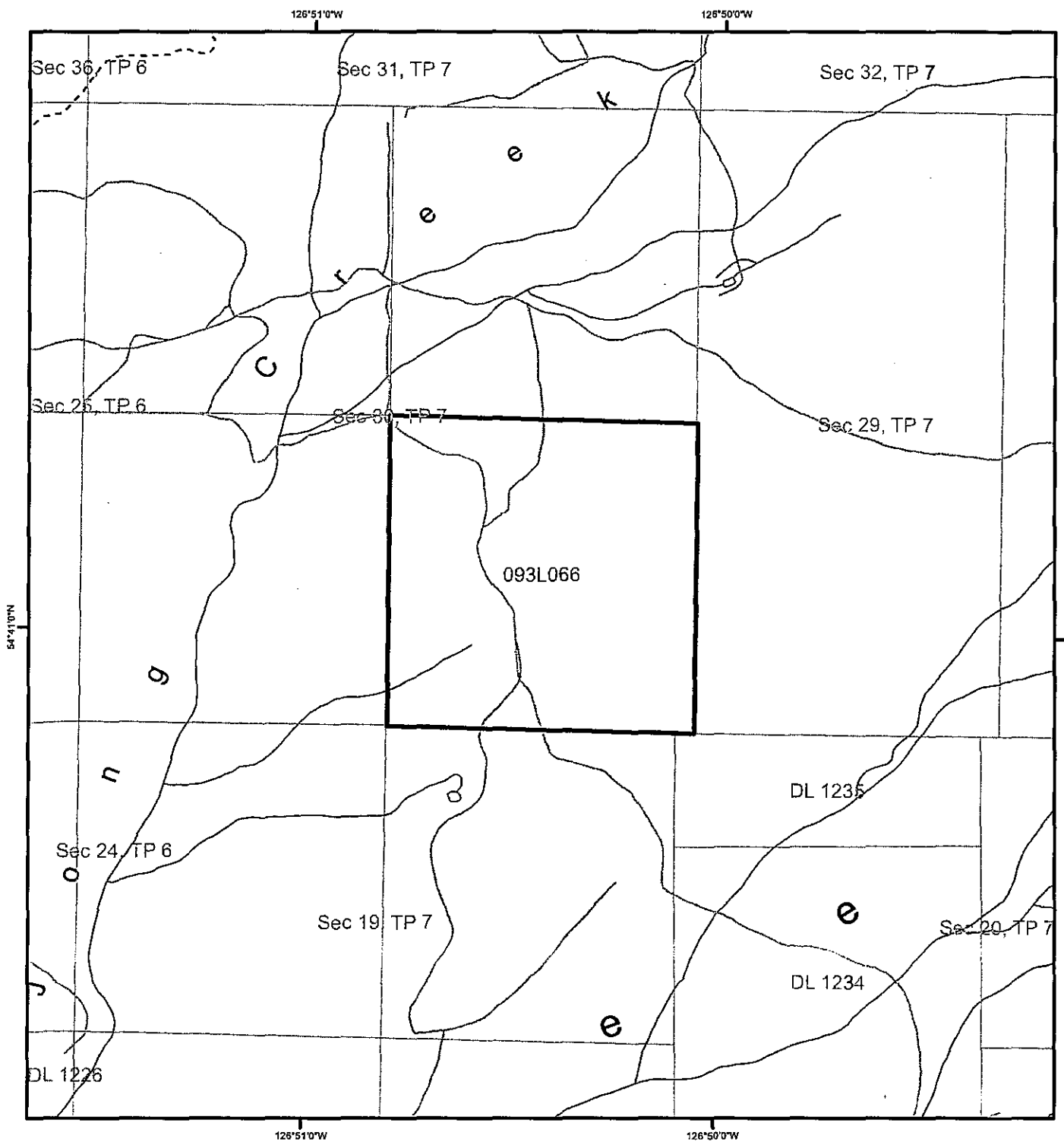

REGIONAL DISTRICT OF BULKLEY-NECHAKO COMMENT SHEET ON CROWN LAND REFERRAL 6408726

Electoral Area:	A
Applicants:	Gail Burnett and Kevin McCreery
Existing Land Use:	Agriculture / Forested
Zoning:	Agricultural (Ag1) in Regional District of Bulkley-Nechako Zoning Bylaw No. 700, 1993
Plan Designation	Agricultural (Ag) in Smithers Telkwa Rural OCP
Proposed Use Comply With Zoning:	Yes
If not, why?	
Agricultural Land Reserve:	In the ALR
Access Highway:	Deception Lake FSR or Robin Creek Rd
Archaeological Site:	Not according to our mapping
Building Inspection:	In the building inspection area
Fire Protection:	Outside of Rural Fire Protection Area
Other comments:	None



Scale: 1:15,000
 Purpose: AGRICULTURE
 Subpurpose: DIRECT SALE
 Type: CROWN GRANT
 Subtype: MAP RESERVE

Legend

-  Application Area
-  Indian Reserves
-  Parks & Protected Areas



Referral Map



Date: 25 Jul 2014

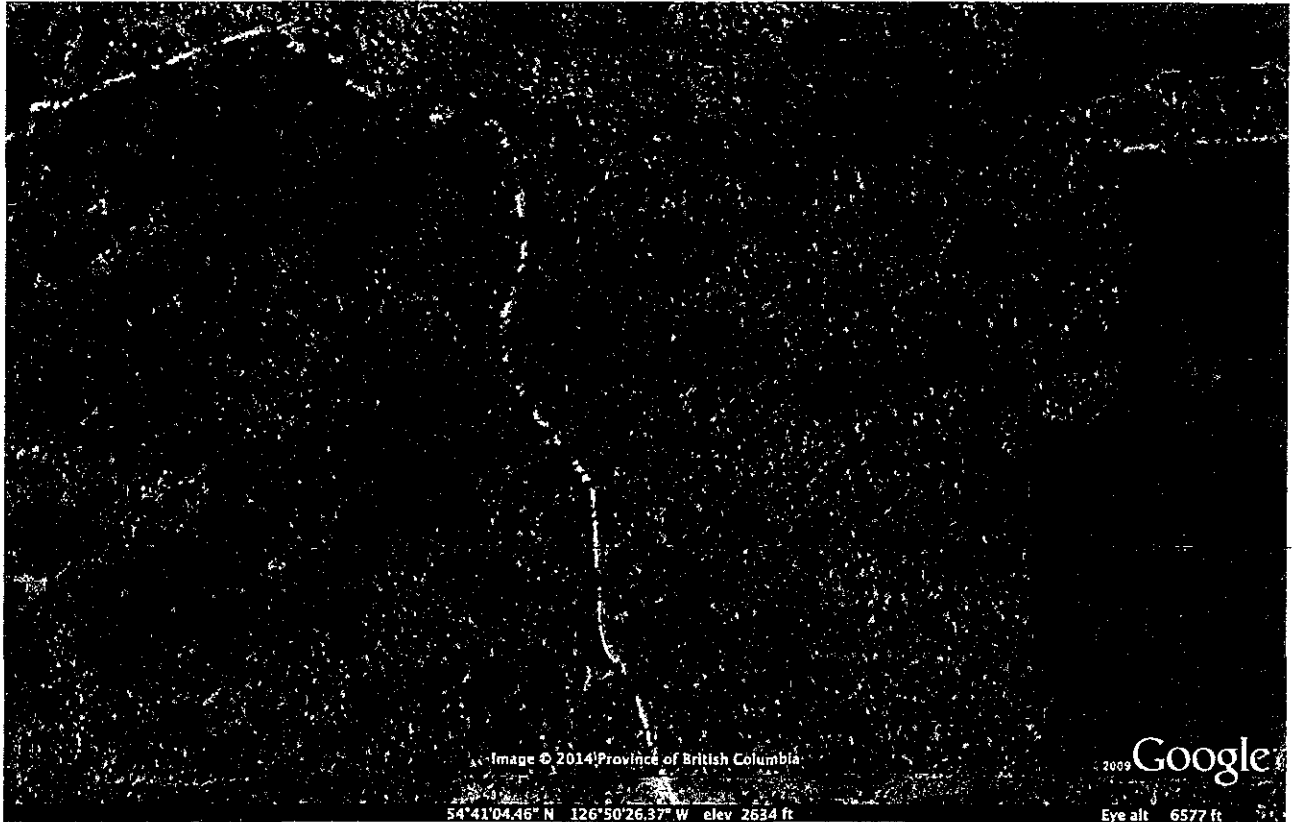

Pink lines enclose proposed areas of cultivation (2) leaving the area of the spring runoff (blue lines) with a buffer zone. We also plan to leave a treed area between the application land and the private land to the south. There will be a shelter-belt between the cultivation areas and the fences to help retain moisture and reduce weeds from blowing in to cultivations, with the exception of where the fence attaches to our private hayfield to the east.

We would like to leave the low areas in the southwest quarter below the road to filter any spring runoff. The land here in this low area is, in part arable, but some of the swells are swamp like and it would be a good area to leave alone.

The land is fenced on two sides; on East side the land is owned by us and is fenced, and on the South side the land is privately owned and also fenced. The land is unfenced on the West and North sides and we propose to do the fencing in the second year. The Northwest corner will be fenced in such a manner that will allow sufficient room for the cattle grazing to be able to access the Northeast quarter of section 30.

Propose to log merchantable timber in the first and second year after purchase in the areas to be cultivated. The logging is proposed to take place in the winter months to minimize disturbance. Mature timber would be logged so that the stumpage would be paid. Mature timber, if any, in wet areas would be tipped out of wet area so as to avoid entering these areas with equipment.

Once the logging is complete, stumping, piling and preparation to disc would be started. Within three to four years, we would like to have the proposed cultivation areas into grain production.

Soil information and map by the Experimental Farms Service, Canada Dept. Of Agriculture and BC Dept of Agriculture, in co-op with UBC circa 1951 from maps supplied by Dept of Lands and Forests BC

SOIL LEGEND

SOILS OF THE NECHAKO PLAIN DEVELOPED FROM WATER DEPOSITED I





Ag Land Sec 30 SE ¼ is classified with this type of soil and grouped as DB

	SOIL NAME	PARENT MATERIAL	NATURAL DRAINAGE	TOPOGRAPHY
Pi	Pinchi Heavy Clay	Lacustrine Clay	Moderately Well to Poor	Undulating
FJ	Fort St. James Heavy Clay	" "	Moderately Well to Poor	"
V	Vanderhoof Silty Clay	" "	" " to Imperfect	" to Rolling
Nu	Nulki Clay	" "	Well Drained	" to Gently Rolling
P	Pineview Clay	" "	Moderate to Poor	Undulating
Nc	Narcoli Clay	" "	Well to Moderately Well Drained	" to Gently Rolling
T	Telkwa Clay	" "	" " " " "	" " " "
Do	Doughty Clay	" "	Moderately Well to Imperfect	" " " "
B	Bednesti Silt Loam	Silty Lacustrine Material	Well Drained	Undulating to Rolling
Prsil	Prairiedale Silt Loam	" " "	" "	Undulating
Prsil	Prairiedale Silty Clay Loam	" " "	" "	"
Mls	Mapes Loamy Sand	Alluvial Sands	Excessively Drained	Undulating
Mal	Mapes Sandy Loam	" "	" "	"
Els	Eena Loamy Sand	Alluvial Outwash, Compound Eskers, etc.	" "	"
Est	Eena Sandy Loam	Alluvio-Lacustrine Sands	" "	Hilly Undulating
Cu	Cuisson Clay Loam	Alluvio-Lacustrine	Moderate to Well Drained	"
Sls	Saxton Loamy Sand	Alluvial Sandy Material	Generally Excessive	Undulating
Ssl	Saxton Sandy Loam	" " "	" "	"
Gi	Giscome Gravelly Sandy Loam	Coarse Sandy Gravelly Alluvium	" "	"
Brls	Braeside Loamy Sand	Alluvial Sandy Material	" "	"
Brs	Braeside Sandy Loam	" " "	" "	"
Krs	Kersley Sandy Loam	" " "	" "	"
Krs	Kersley Loamy Sand	" " "	" "	"
F	Fraser Silt Loam	Alluvial Silt Loam	Poor to Moderate	Level to Undulating
N	Nechako Silt Loam	" " "	Poor to Well Drained	" " "
As	Asotin Silt Loam	" " "	Well Drained	" " "
As	Asotin Clay Loam	" " "	" " "	" " "

SOIL COMPLEXES	
Driftwood	Driftwood —Driftwood Complex
V-Pr	Driftwood —Prairiedale Complex
V-C	Driftwood —Chilako Complex
Do-Ba	Driftwood —Barrett Complex
P-C	Prairieview —Chilako Complex
Ke-A	Kensley —Australian Complex
T-D	Tahara —Driftwood Complex
Gu-G	Guise —Chilako Complex
P-N	Prairieview —Narcosli Complex

Ag Land Application
Sec 30 SE ¼ is classified
as DB

SOIL GROUPS	
DB	Degraded Black
GW	Gray Wooded
P	Podsol Soils of the Pacific Coast
GWP	Groundwater Podsol
A	Alluvial
B	Bog Soils
DGGI	Dark Gray Gleisolic
LT	Land Type

TOPOGRAPHIC CLASSES	
	Level to Undulating
	Gently Rolling to Moderately Sloping—Dominant Slopes 3%—7%
	Rolling, Steeply Sloping—Dominant Slopes 7%—25%
	Hilly, Mountainous—Dominant Slopes Greater Than 25%

10'

128° 00'

50'

Canada Department of Agriculture,
in cooperation with the University of

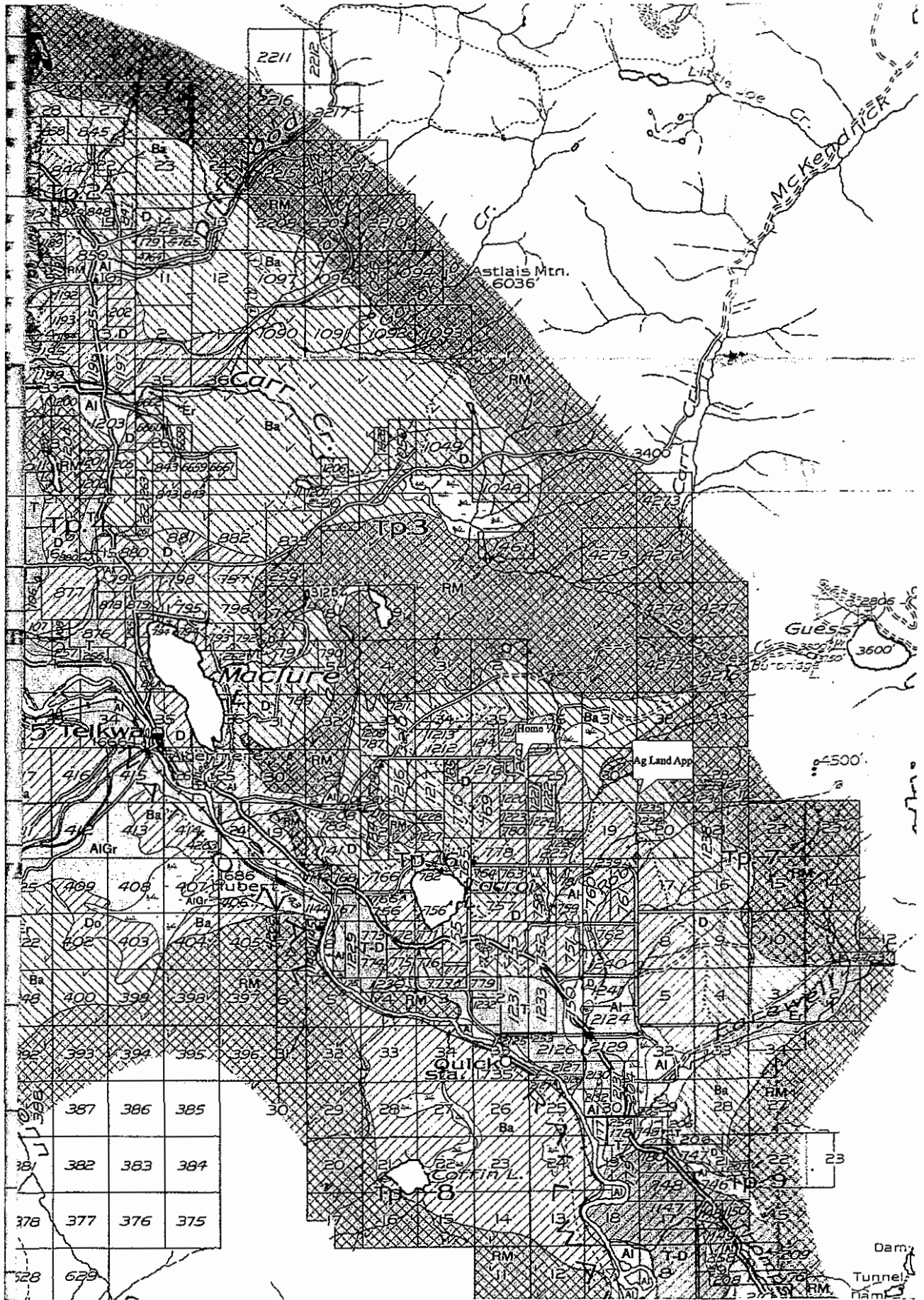

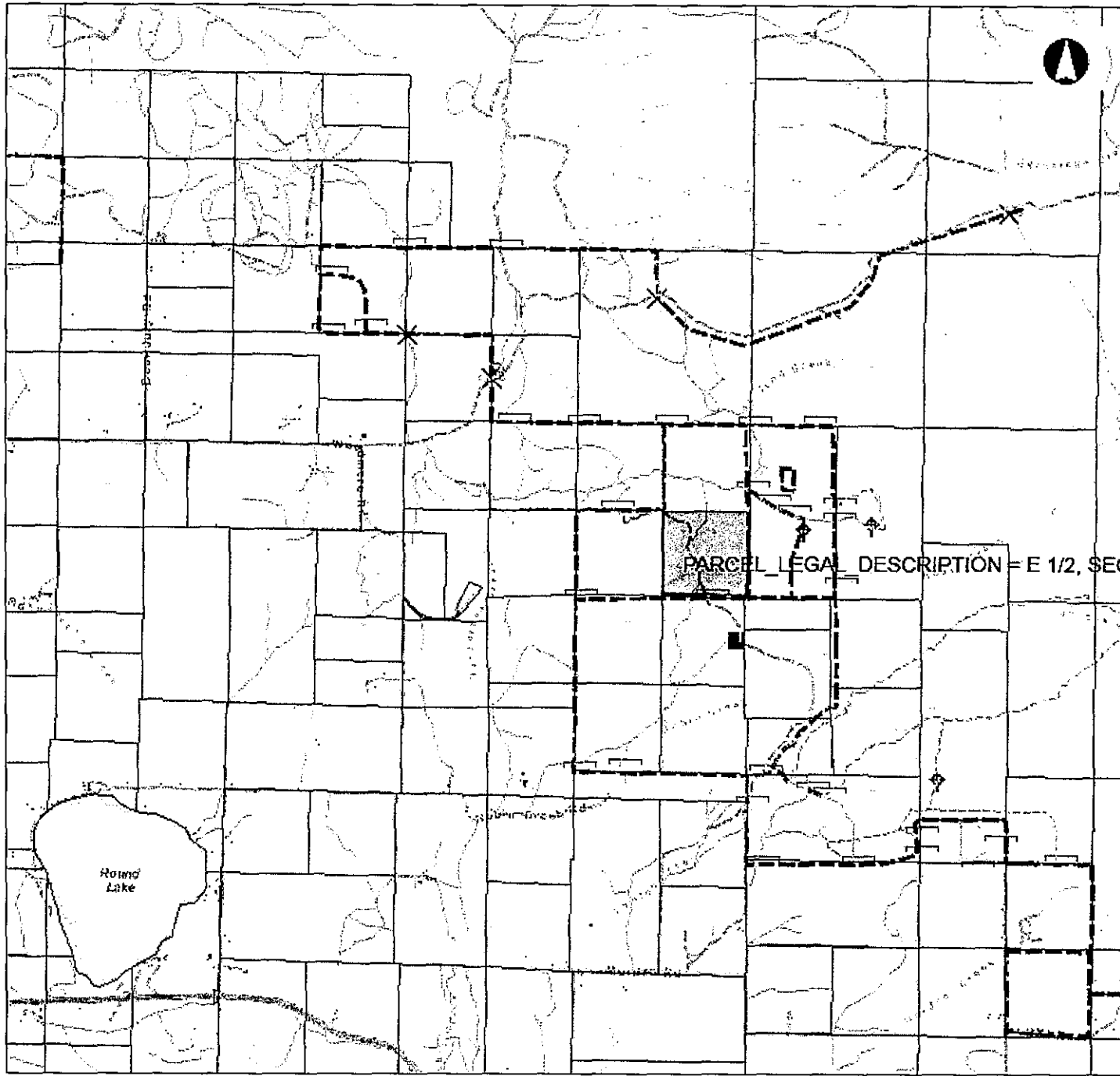

AG application

Legend

- Land Act Survey Parcels - T
- Land Act Survey Parcels - T Descriptions
- Transportation - Roads, Rail (1:20,000)
- FCODE
- Airfield
- Airport
- Airstrip
- Airport Abandoned
- Ferry Route
- Road
- Road (Gravel Undivided) - 1 Lar
- Road (Gravel Undivided) - 2 Lar
- Road (Gravel Undivided) - U C -

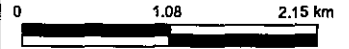

1: 52,961

Copyright/Disclaimer

The material contained in this web site is owned by the Government of British Columbia and protected by copyright law. It may not be reproduced or redistributed without the prior written permission of the Province of British Columbia. To request permission to reproduce all or part of the material on this web site please complete the Copyright Permission Request Form which can be accessed through the Copyright Information Page

CAUTION: Maps obtained using this site are not designed to assist in navigation. These maps may be generalized and may not reflect current conditions. Uncharted hazards may exist. **DO NOT USE THESE MAPS FOR NAVIGATIONAL PURPOSES.**

Datum: NAD83
Projection: NAD_1983_BC_Environment_AJbars

Key Map of British Columbia

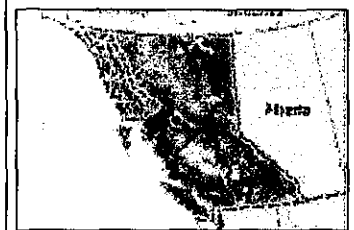

47



45

MEMORANDUM

To: Rural Directors
From: Maria Sandberg, Planner
Date: September 29, 2014
Re: Land Referral File No. 7409736, K & D Logging

This application is a combined Mines Act Notice of Work and Crown Land Licence of Occupation for Quarry purposes. The application area is located in a woodlot that has been harvested. The quarried materials are planned to be used to do site improvements to the former Northern Interior Forest Products yard in Fort St James. The project will include pit run, screening and potentially crushing.

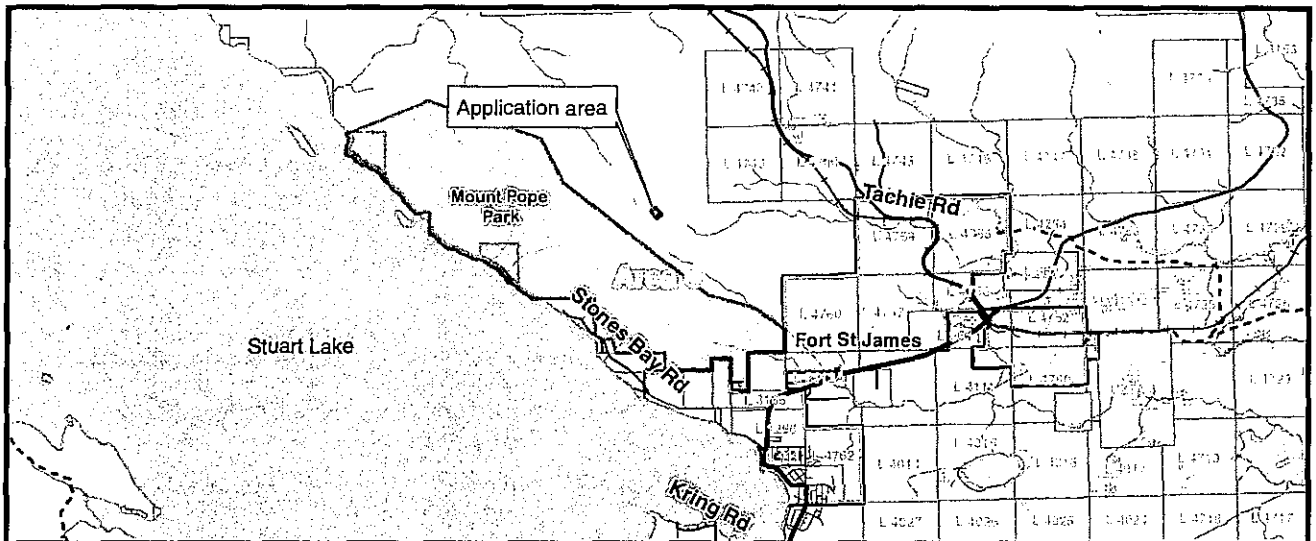

The application area is located on un-surveyed Crown Land, 3 kilometres northeast of the District of Fort St James. The application area is approximately 2.5 ha in size.

The application area is not zoned.

Recommendation

That the attached comment sheet be provided to the Province as the Regional District's comments on Crown land application 7409736.

Rural Directors – All/Directors/Majority

Reviewed by:

Jason Llewellyn
Director of Planning

Written by:

Maria Sandberg
Planner



REGIONAL DISTRICT OF BULKLEY-NECHAKO COMMENT SHEET ON CROWN LAND REFERRAL 7409736

Electoral Area:	C
Applicant:	K & D Logging Ltd.
Existing Land Use:	Vacant
Zoning:	None
Plan Designation	None
Proposed Use Comply With Zoning:	N/A
If not, why?	
Agricultural Land Reserve:	Not in the ALR
Access Highway:	Forest Service Roads
Archaeological Site:	Not according to our mapping
Building Inspection:	Not within the building inspection area
Fire Protection:	Not within a Rural Fire Protection Area
Other comments:	None

124°19'0"W

124°18'0"W

124°17'0"W

54°31'0"N

54°31'0"N

SITE MAP
 BCGS Mapsheet: 93K049
 Lat/Long: 54° 29' 42.156" N 124° 17' 52.598" W

47

42

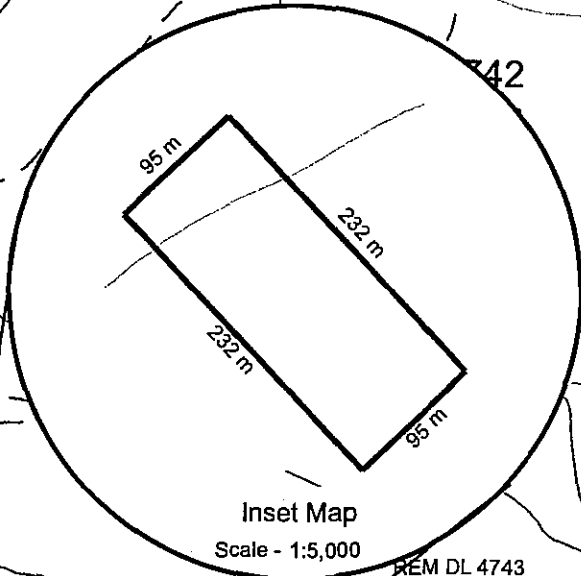

93K.059

REM DL 4743
DL 4743

54°30'0"N

54°30'0"N



93K.049

**MOUNT POPE
PARK**

54°29'0"N

54°29'0"N

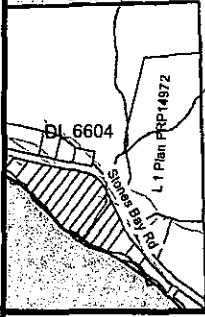



48

MEMORANDUM

To: Rural Directors
From: Maria Sandberg, Planner
Date: September 18, 2014
Re: Land Referral File No. 7409737

This application is regarding the direct sale of Crown Land for extensive agricultural purposes. The application area is located approximately 12 kilometres north of the District of Fort St James, and is ± 64.4 ha in size. The applicants own land in the vicinity of the application area.

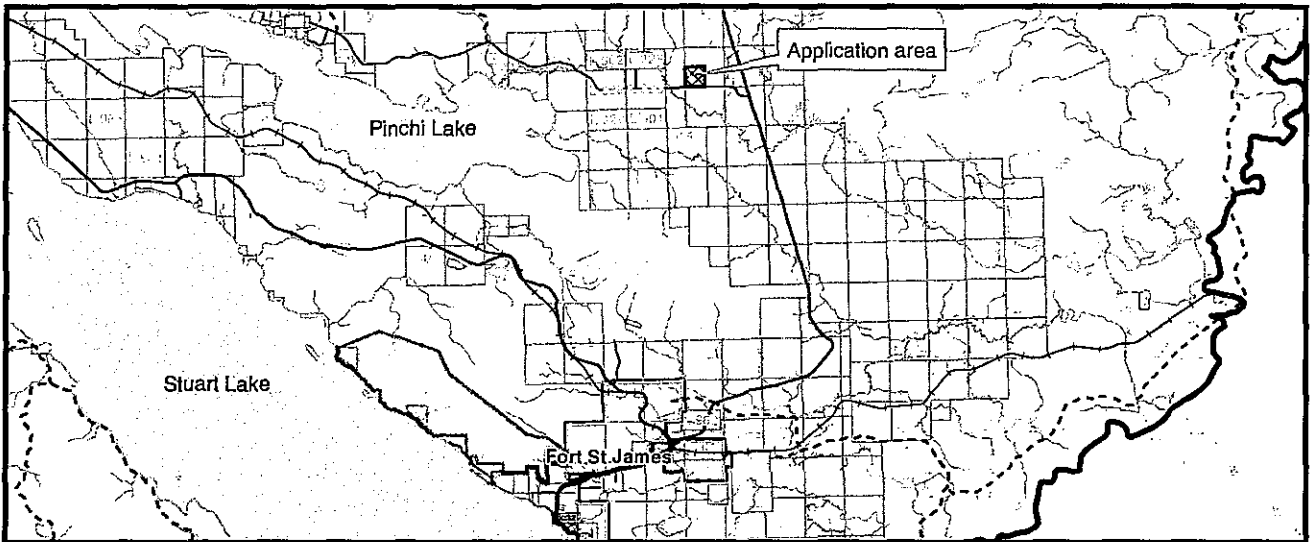

The application area is located within the Agricultural Land Reserve (ALR) and is not currently zoned in Regional District Zoning Bylaw No. 700, 1993. The application area is designated as Agricultural (Ag) in the Fort St. James Rural Official Community Plan Bylaw No.15178, 2010.

As the application area is located in the ALR, the Province is advised to consult with the Agricultural Land Commission regarding the proposed subdivision.

Recommendation

That the attached comment sheet be provided to the Province as the Regional District's comments on Crown land application 7409737.

Rural Directors – All/Directors/Majority

Reviewed by:

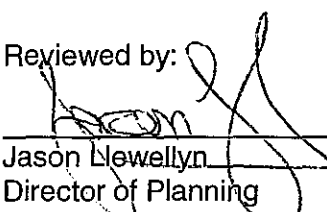
Jason Lewellyn
Director of Planning

Written by:

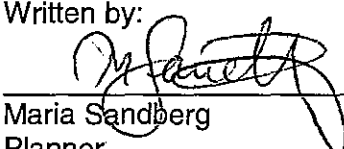
Maria Sandberg
Planner



REGIONAL DISTRICT OF BULKLEY-NECHAKO COMMENT SHEET ON CROWN LAND REFERRAL 7409737

Electoral Area:	C
Applicants:	John Hiebert and Melvin Henderson
Existing Land Use:	Forested
Zoning:	No zoning
Plan Designation	Agriculture (Ag) in Fort St. James Rural Official Community Plan Bylaw No.1578, 2010
Proposed Use Comply With Zoning:	n/a
If not, why?	
Agricultural Land Reserve:	In the ALR
Access Highway:	Pinchi Lake Rd
Archaeological Site:	Not according to our mapping
Building Inspection:	Not within the building inspection area
Fire Protection:	Outside of Rural Fire Protection Area
Other comments:	The Province is advised to consult with the Agricultural Land Commission regarding the proposed subdivision, as the application area is located in the ALR

50

SITE MAP

BCGS Mapsheet: 93K070

Lat/Long: 54° 36' 23.146" N 124° 10' 13.511" W

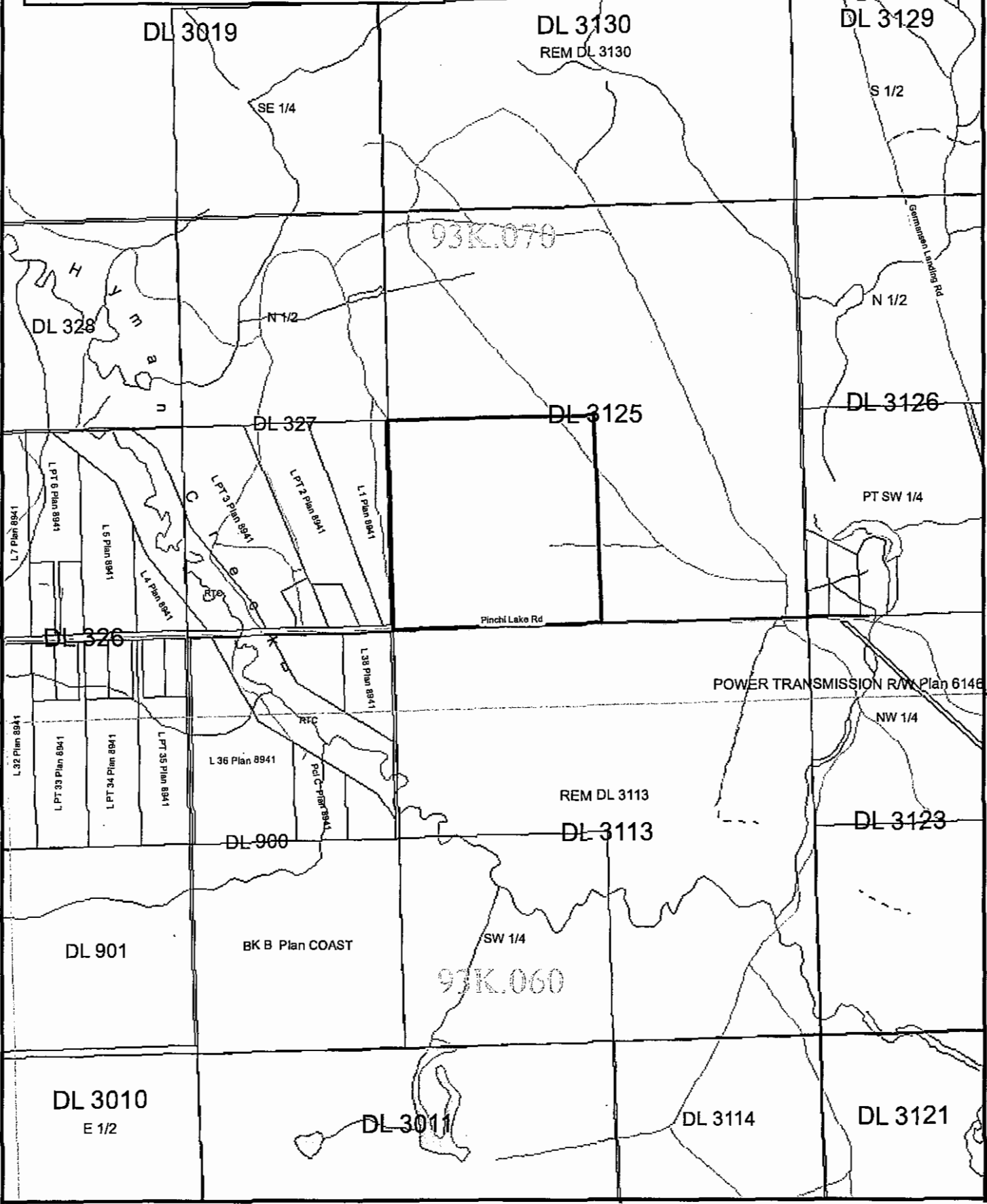



51

MEMORANDUM

To: Rural Directors
From: Maria Sandberg, Planner
Date: September 29, 2014
Re: Land Referral File No. 7409739, Ministry of Transportation and Infrastructure

This application is regarding a Section 16 Map Reserve application for Aggregate and Quarry Materials rip rap purposes. The application area is located on un-surveyed Crown Land, 17 kilometres northeast of the Village of Fraser Lake, and is accessed by the Sutherland Forest Service Rd. The application area is approximately 4 ha in size.

According to our records the nearest residence is located on Becker Rd, approximately 5 kilometres southeast of the application area.

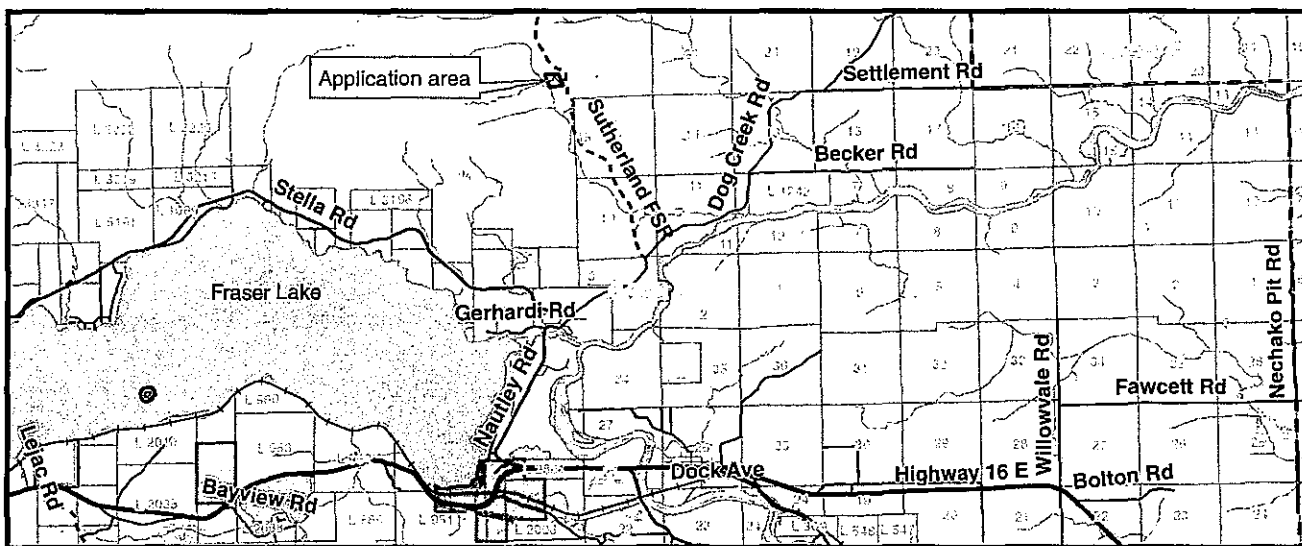

The application area is not zoned.

Recommendation

That the attached comment sheet be provided to the Province as the Regional District's comments on Crown land application 7409739.

Rural Directors – All/Directors/Majority

Reviewed by:

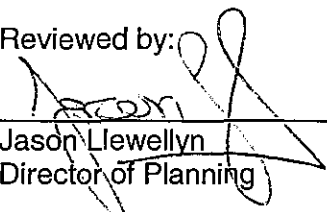
Jason Llewellyn
Director of Planning

Written by:

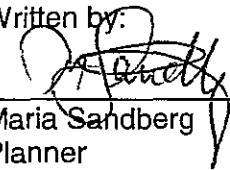
Maria Sandberg
Planner



**REGIONAL DISTRICT OF BULKLEY-NECHAKO COMMENT
SHEET ON CROWN LAND REFERRAL 7409739**

Electoral Area:	D
Applicant:	Ministry of Transportation and Infrastructure
Existing Land Use:	Vacant
Zoning:	None
Plan Designation	None
Proposed Use Comply With Zoning:	N/A
If not, why?	
Agricultural Land Reserve:	Not in the ALR
Access Highway:	Sutherland FSR
Archaeological Site:	Not according to our mapping
Building Inspection:	Not within the building inspection area
Fire Protection:	Not within a Rural Fire Protection Area
Other comments:	None

124°37'0"W

124°36'0"W

124°35'0"W

124°34'0"W

53

SITE MAP

BCGS Mapsheet: 93K018

Lat/Long: 54° 7' 51.574" N 124° 35' 47.307" W

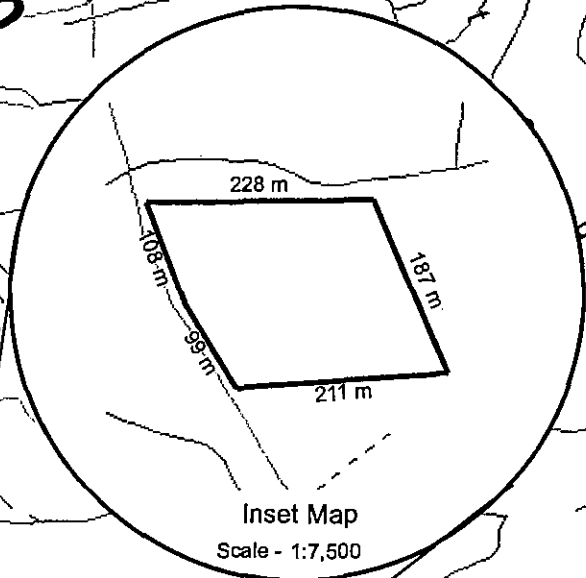

54°50'N

54°50'N

54°50'N

54°50'N

93K.017

93K.018

N 1/2

Sec 15, TP 17

SW 1/4

SE 1/4

Sec 10, TP 17

PT W 1/2

L.A. Plan BCP 7974

W 1/2 NE 1/4
DTU 1136

E 1/2 NE 1/4

54°70'N

54°70'N

Sullivan Fork FSR



54

MEMORANDUM

To: Rural Directors
From: Maria Sandberg, Planner
Date: September 18, 2014
Re: Land Referral File No. 0284064

This application is for the purchase of Crown land which the applicants currently lease. The subject property (Lot 15, District Lot 1352, Range 5, Coast District, Plan 5380) is located at 48840 Mill Bay Rd, on the western shore of Babine Lake, south of the Village of Granisle. This subdivision was created to provide Crown recreational lease lots however, the majority of these lots are now privately owned. The majority of parcels in this area are developed.

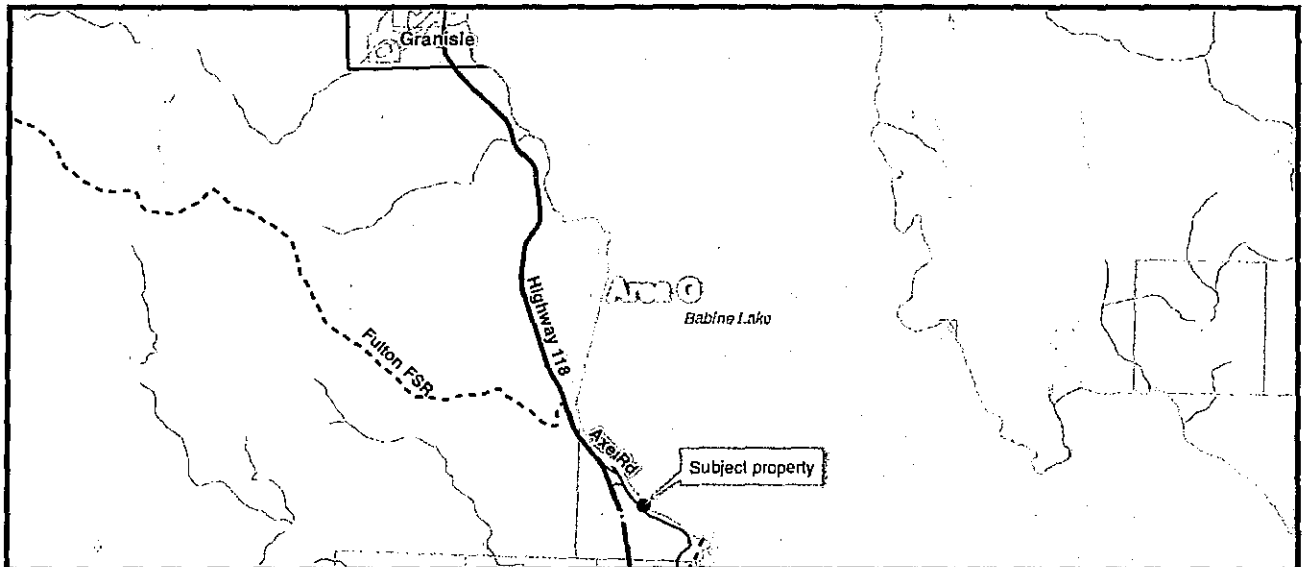

The subject property is 0.13 ha in size and is R4 (Waterfront Residential II). The property is smaller than the 0.8 ha minimum parcel size required for subdivision in the R4 zone.

The property contains a dwelling which appears to be used by the property owner for recreational purposes. There is a building permit from 1975 on file, for the construction of a cottage.

In situations such as this, where the parcel is relatively small, achieving appropriate on-site sewage disposal may be challenging, and a more expensive Type 2 or 3 system, or a pump and haul system, may be required. As there is an existing dwelling on the property, it is recommended that the Province ensure that any sewage disposal system on the property was installed, and is being operated, in accordance with provincial regulations, prior to the sale of the property.

Recommendation

That the attached comment sheet be provided to the Province as the Regional District's comments on Crown land application No. 0284064.

Rural Directors – All/Directors/Majority

Reviewed by:



Jason Lewellyn
Director of Planning

Written by:

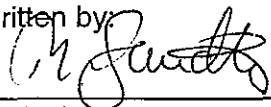

Maria Sandberg
Planner



**REGIONAL DISTRICT OF BULKLEY-NECHAKO COMMENT
SHEET ON CROWN LAND REFERRAL No. 0284064**

Electoral Area:	G
Applicants:	Warren and Kelly Labrie
Existing Land Use:	Recreational residential
Zoning:	Waterfront Residential II (R4) in Regional District of Bulkley-Nechako Zoning Bylaw No. 700, 1993
Plan Designation	Lakeshore (L) in the Houston, Topley & Granisle Rural OCP
Proposed Use Comply With Zoning:	
If not, why?	
Agricultural Land Reserve:	In the ALR
Access Highway:	Mill Bay Rd
Archaeological Site:	Not according to our mapping
Building Inspection:	Within the building inspection area
Fire Protection:	Outside Rural Fire Protection Area
Other comments:	That the Ministry of Forests, Lands and Natural Resource Operations be requested to ensure that any sewage disposal system on the property was installed, and is being operated, in accordance with provincial regulations, prior to the sale of the property.

Management Plan.

July 4th 2014

- We currently have a lease at:
 - Lot 15 District Lot 1352 Range 5 Coast District Plan 5389
- Brief description of the property =
 - Lake frontage lot 100 x 130 (in size)
 - accessed by Millbay Road
- Property presently has:
 - 33' x 24' cabin located on the property
- We would like to purchase this said property because we would like to build a larger primary residence. We would also like to start this within 5 years.
- Present sewage management:
 - Black water - contained 550 gal. tank
 - Grey water - septic field (existing)
- Future Plans for upgrading residence
 - upgrade existing sewage management system.

58 ↙

SCALE 1 INCH = 100 FT

BABINE LAKE

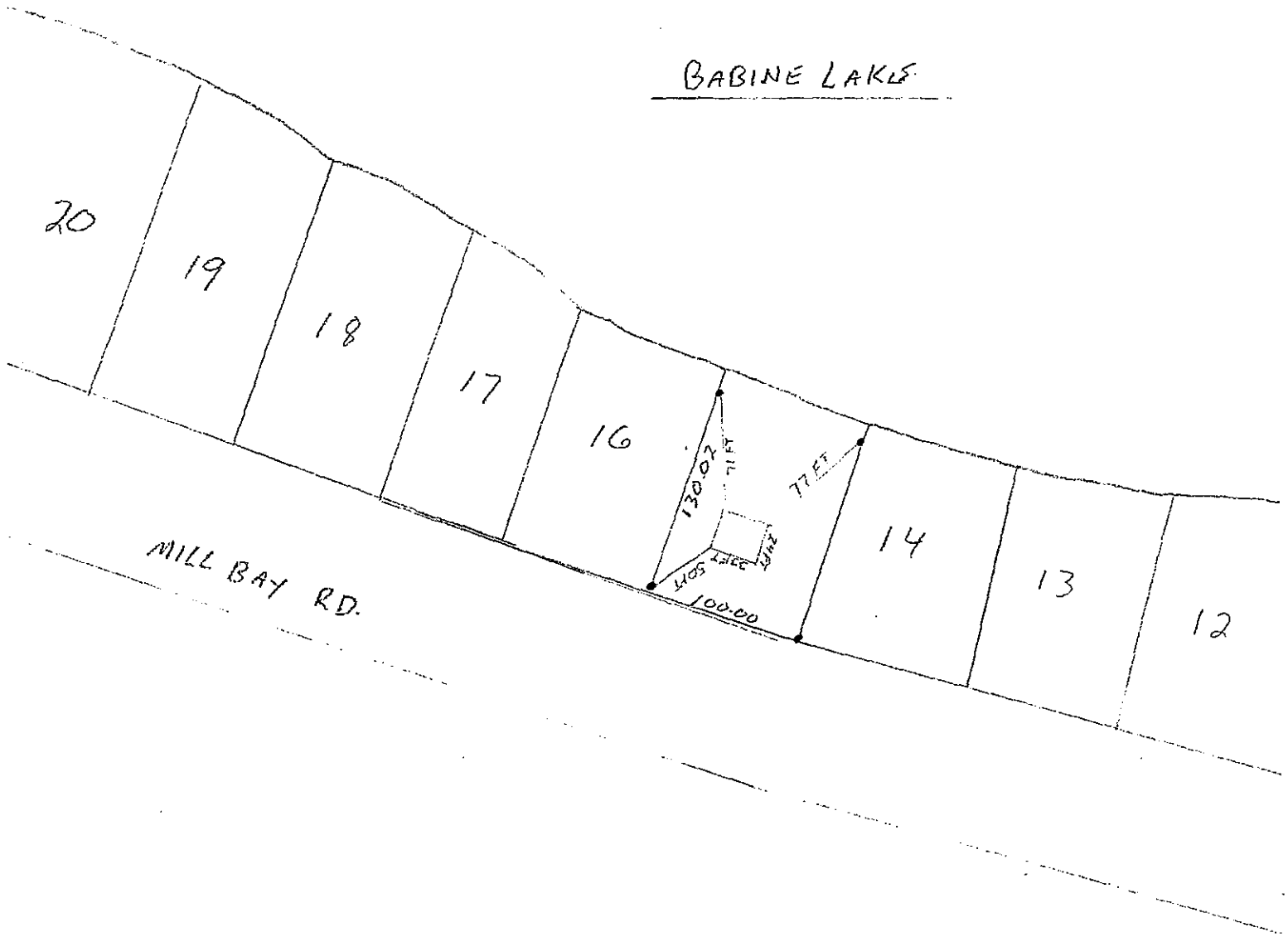

- LOT 15 DISTRICT LOT 1352 RANGE
5 COAST DISTRICT PLAN 5389

- PID 010 446 851

- ACCT 39 755 11955.000 16

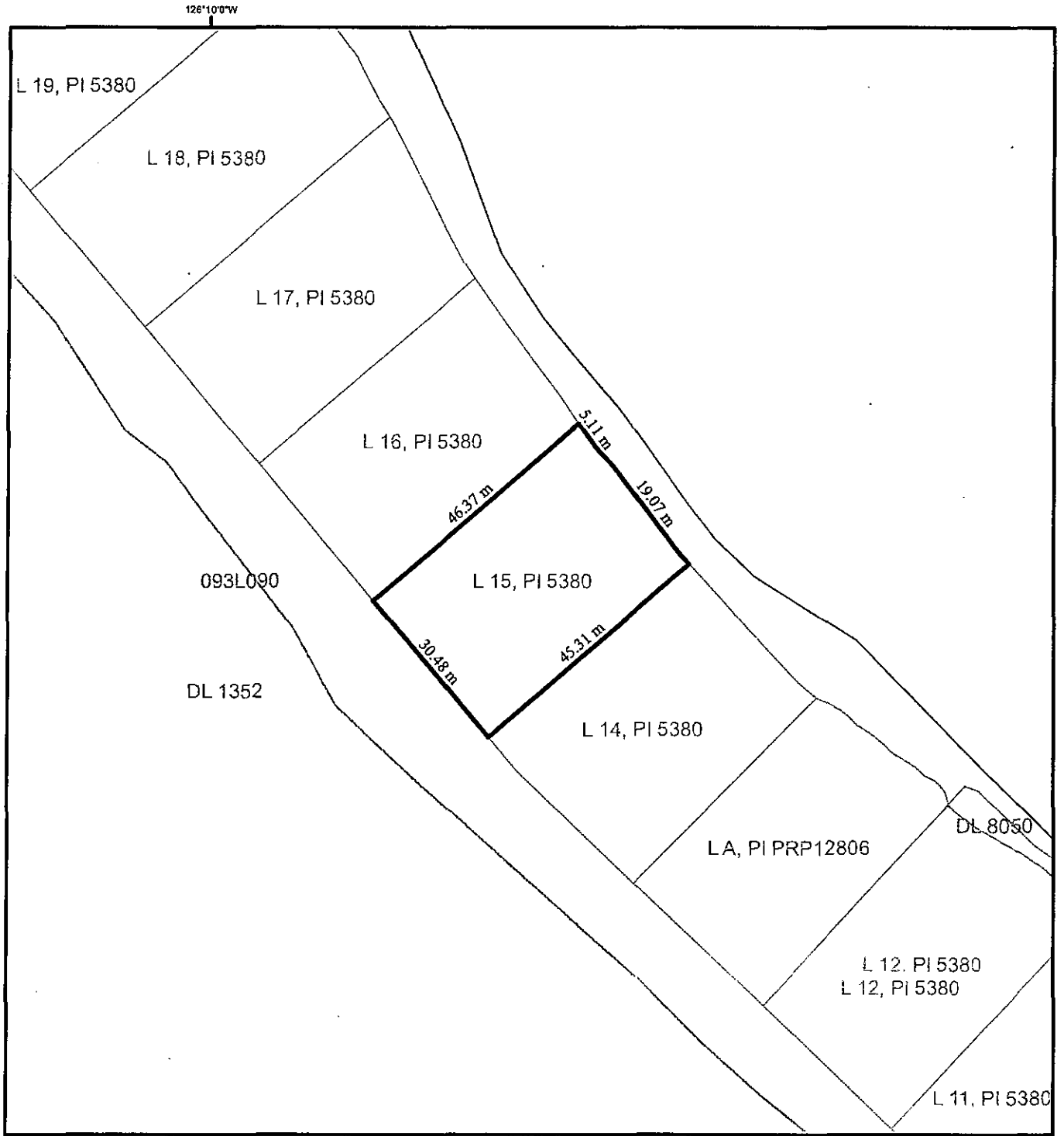

Scale: 1:1,000
 Purpose: RESIDENTIAL
 Subpurpose: RURAL RESIDENTIAL
 Type: CROWN GRANT
 Subtype: DIRECT SALE

Legend

-  Application Area
-  Indian Reserves
-  Parks & Protected Areas



Referral Map



Date: 29 Jul 2014